

Genesee County Land Bank Authority Blight Elimination Program
Request for Proposals- LB 18-007 Environmental Abatement, Demolition and Restoration of
1518 Averill Ave, Former Kirkwood Mobile Home Park
ADDENDUM #1

April 17, 2018

The following information is to be incorporated into the bidding and contract documents and acknowledged by all bidders for the above referenced project. Bids submitted that do not acknowledge this Addendum will be deemed incomplete and may be rejected on such basis.

1. **General Questions and Answers** are included in Attachment 1 along with the Pre-bid Meeting Sign-in Sheet. y

2. **Corrected Important Dates:** Important dates regarding the Work are as follows:

| | |
|---|--|
| Mandatory Pre-Bid Meeting | Thursday, April 12, 2018 2:00 pm on site at 1518 Averill Ave. |
| Bids Due | Tuesday, April 24, 2018 |
| Notice of Award | On or around Monday, April 30, 2018 |
| Contract Signed | On or around Friday, May 4, 2018 |
| Start Work | On or around Monday, May 7, 2018 |
| Final-grade, seed and straw work completed | On or before Friday, June 15, 2018 |
| Final Paperwork and Payment Request | On or before Friday, June 22, 2018 |

Final questions regarding this RFP should be submitted in writing via email to **ffinholm@thelandbank.org** by no later than 3:30pm on Thursday, April 19, 2018.

3. **Corrected Scope:** Existing large boulders on surface elevation of site to remain.
4. **Wage Rate Schedule:** Please note that technical specifications state that work under this RFP is covered by the Davis Bacon Act (DBA). As a demolition only project with no follow on construction, the work under this RFP is actually not covered by DBA (https://www.hud.gov/sites/documents/DOC_14999.PDF); however, the work is covered by the Genesee County Prevailing Wage policy and appropriate prevailing wages per the State of Michigan shall be paid to all workers on site. The most recent prevailing wage rate schedule is attached (Attachment 2).
5. **Revised Scoring and Evaluation Criteria:** Please find revised Appendix 8: Scoring and Evaluation Criteria attached (Attachment 3).



6. **UNIT PRICE SCHEDULE FOR NON-SCOPE WORK ADD/DEDUCT:** Bidders are to provide unit rate prices for the items listed in Attachment 4.

Each bidder must acknowledge receipt of this addendum on RFP SUBMITTAL REQUIREMENTS CHECKLIST.

****END OF ADDENDUM****

Prepared by:
Genesee County Land Bank
452 S. Saginaw St., Second Floor

ATTACHMENT 1

1. Q: Are stumps to be removed?

A: Yes.

2. Q: Contractors expressed concern about removing all underground utilities like wires, etc. for Consumers. Concerned could cause damage to sewers, other underground infrastructure, exasperate any contamination that may be on site. What will City require for open hole/backfill certification?

A: Contractors are required to complete 100% removal of all structures, including foundations, footings, and basements. Regarding trailers, pads, pedestals and all other improvements on site, contractor is to remove all above ground improvements and all below ground improvements up to 2 ft in depth. Demolition of structures with foundations, footings, and basements require 100% removal regardless of depth.

3. Q: Are there drawings showing underground infrastructure? (Utility prints?)

A: Yes. Attached.

4. Q: What is the City's policy on water hydrants?

A: The City of Flint has a limited number of meters available, the largest being 3 inches. Contractor will need to contact the City of Flint Water Service Center and Flint Fire Department to determine availability and coordinate use as the City will attach and remove meters. Contractor is responsible for ensuring water is on site and available at all times, despite availability of meters through the City of Flint.

5. Q: How to handle trailers that cannot safely be abated?

A: Based on ATC's site reconnaissance all trailers were accessible and should be abated as specified, however if Trailer(s) is/are deemed "unsafe" a State of Michigan licensed Asbestos Abatement Contractors must perform demolition(s). All demolition debris (including concrete) associated with ordered/emergency demolitions must be adequately wet, placed in lined trucks or roll-off boxes and properly disposed of as friable asbestos. Additionally, all MIOSHA, Class I asbestos abatement requirements apply.

Contractors should remove asbestos containing materials in structures unless the safety of their workers is compromised. If asbestos is going to be left in place and not removed per NESHAP, then contractors should first remove all asbestos materials that can be safely removed. In the Notice to the State of Michigan, the contractor should state that asbestos will remain in the structure and attach a letter to the notice stating the reasons asbestos is left in place, and provide photo documentation of the safety issues preventing the removal of the identified ACM. OSHA and NESHAP requirements for demolition of structures with asbestos remaining should be followed during the demolition.

6. Q: Is a screen necessary on the fencing?

A: Contractor will not be required to install screen on construction fence. Fencing may encompass the house at 1505 Bingham as it is owned by the Land Bank, though the house is not to be damaged or demolished.

7. Q: Have site drawing that highlights approaches/curb cuts?

A: Yes. Attached.

8. Q: Contractor to regrade/seed ROW?

A: Contractor is responsible to regrade and seed the Right of Way per specification.

9. Q: Can we complete the project in phases (i.e. fence in and complete a portion of the property at a time)?

A: Contractors may complete the demolition in phases. Contractor will need to coordinate with the City of Flint Building and Safety Inspections office if they wish to pursue this course of action. City of Flint Building and Safety Inspections office will need to verify all pads, foundations, and footing have been removed prior to contractor backfilling and finishing. Contractor will be responsible to the City of Flint for any additional inspection fees that may be incurred.

10. Q: It looks like the transformers are the property of Consumers. Will they be removing these before the demolition starts as we need to remove the pads. I assume also that if there are PCB oils to be dealt with on these that Consumers would be handling all of that.

A: Transformers have been removed by others (noted in revised drawing). Consumers will not be removing any remaining transformer pad or ancillary equipment prior to demolition. Any remaining pads or equipment will be the responsibility of the contractor.

11. Q: In the Phase II it identifies some contaminants in the groundwater above acceptable criteria is 2 locations. Will there be "contaminated soil" to be removed as a result of this. Throughout the documents it is clear that if there is, this will be our responsibility to take care of this. As long as these soils remain on the site can they be reused there? If we need to remove, of course there are associated costs which could be significant. Do we have any idea how much we should expect?

A: GCLBA does not anticipate removing any contaminated soil from site. The Environmental Construction Management Plan outlines methods and precautions contractors are to take in dealing with soils. If dewatering is required, Contractor will be required to properly dispose of contaminated water. Pumping to site or sewers is prohibited, without applicable discharge permit.

D-5600

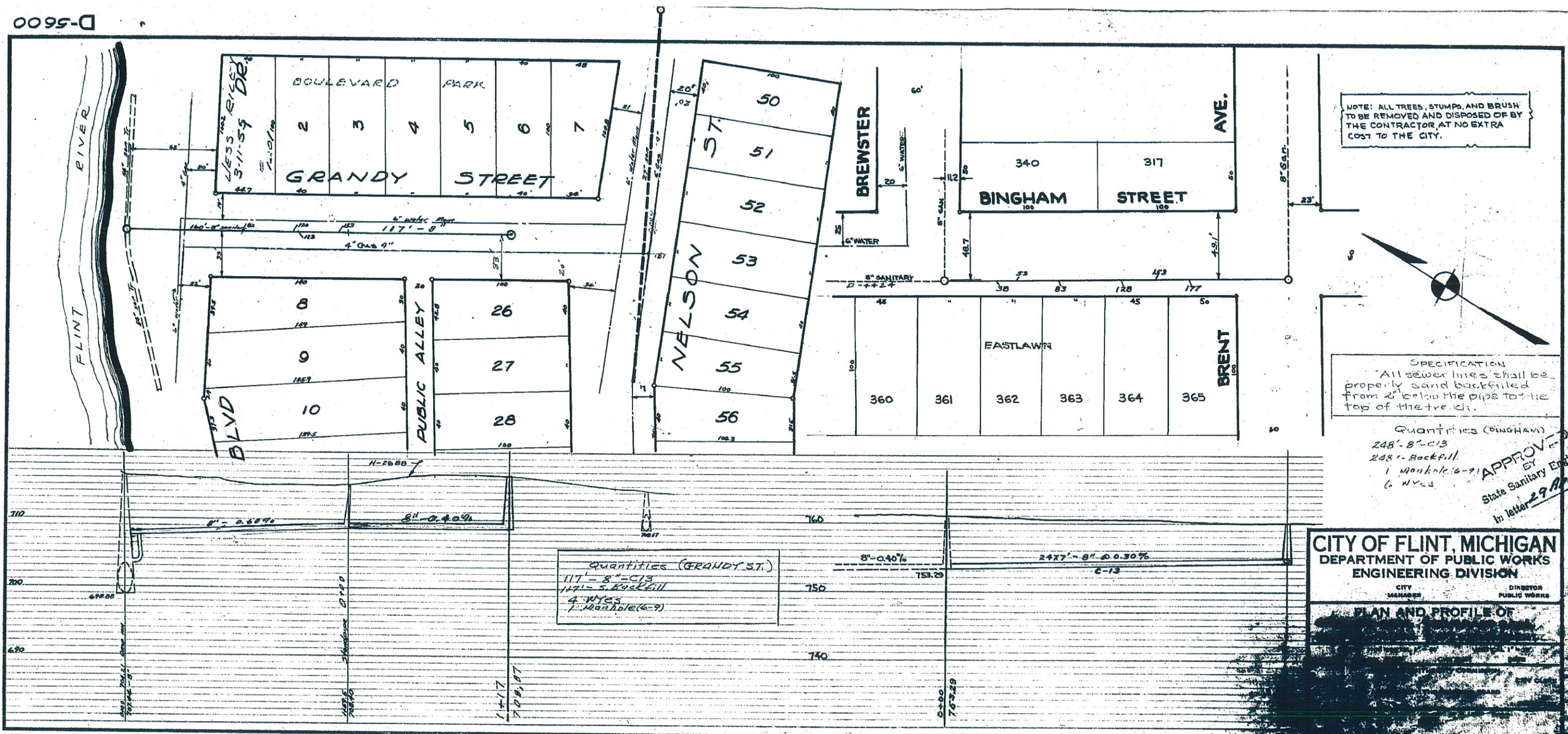

NOTE: ALL TREES, STUMPS, AND BRUSH TO BE REMOVED AND DISPOSED OF BY THE CONTRACTOR AT NO EXTRA COST TO THE CITY.

SPECIFICATION
All sewer lines shall be properly sand backfilled from 2' below the pipe to the top of the trench.

Quantities (BINGHAM)
248'-8\"-C13
248'-Backfill
1 Manhole (6-9)
6 W.V.C.

APPROVED
BY
State Sanitary Engineer
In letter 29 Apr 1955

Quantities (GRANDY ST.)
117'-8\"-C13
117'-Backfill
4 W.V.C.
1 Manhole (6-9)

CITY OF FLINT, MICHIGAN
DEPARTMENT OF PUBLIC WORKS
ENGINEERING DIVISION

CITY MANAGER DIRECTOR
PUBLIC WORKS

PLAN AND PROFILE OF

D-4424

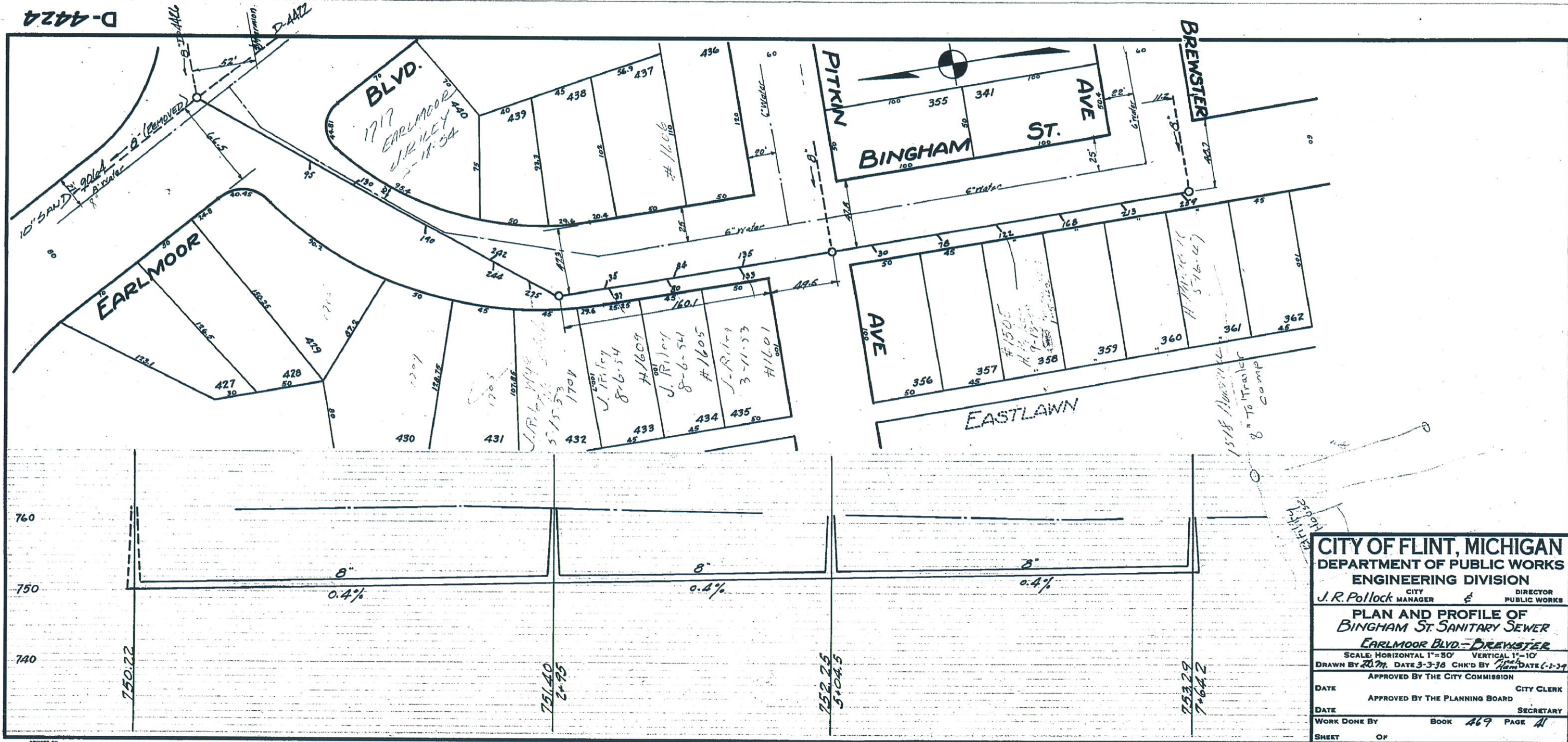

PRINTED ON
"INFERNAL" TANGING CLOTH
R & E CO., N. Y.

D-4424

1659

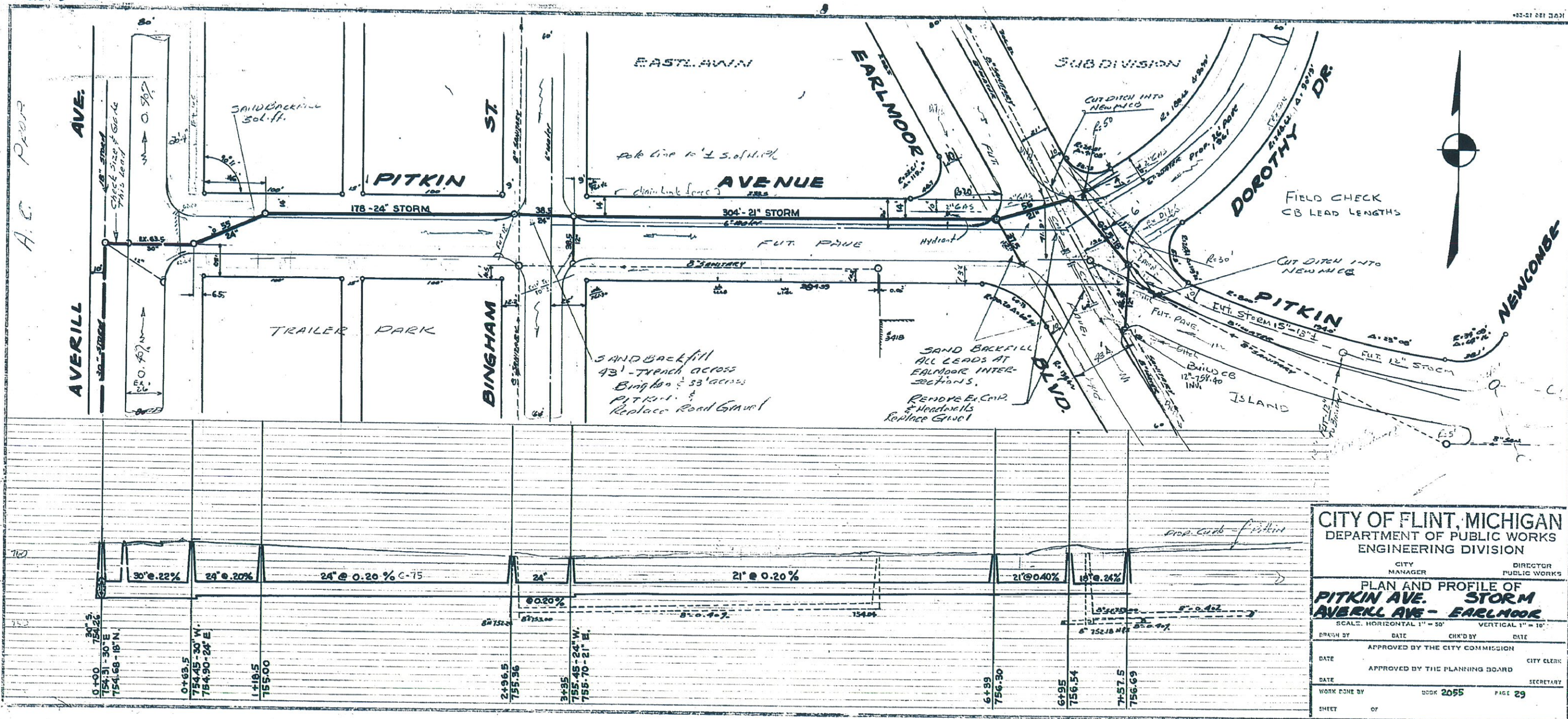

| | | | |
|---------------------------------|--------------------------------|-------------------|--------------|
| CITY OF FLINT, MICHIGAN | | | |
| DEPARTMENT OF PUBLIC WORKS | | | |
| ENGINEERING DIVISION | | | |
| CITY MANAGER | DIRECTOR | | PUBLIC WORKS |
| PLAN AND PROFILE OF | | | |
| PITKIN AVE. STORM | | | |
| AVERILL AVE - EARLMOR | | | |
| SCALE, HORIZONTAL 1" = 50' | | VERTICAL 1" = 10' | |
| DRAWN BY | DATE | CHK'D BY | DATE |
| APPROVED BY THE CITY COMMISSION | | | |
| DATE | APPROVED BY THE PLANNING BOARD | | CITY CLERK |
| DATE | | | SECRETARY |
| WORK DONE BY | BOOK 2055 | PAGE 29 | |
| SHEET | OF | | |

D-6591

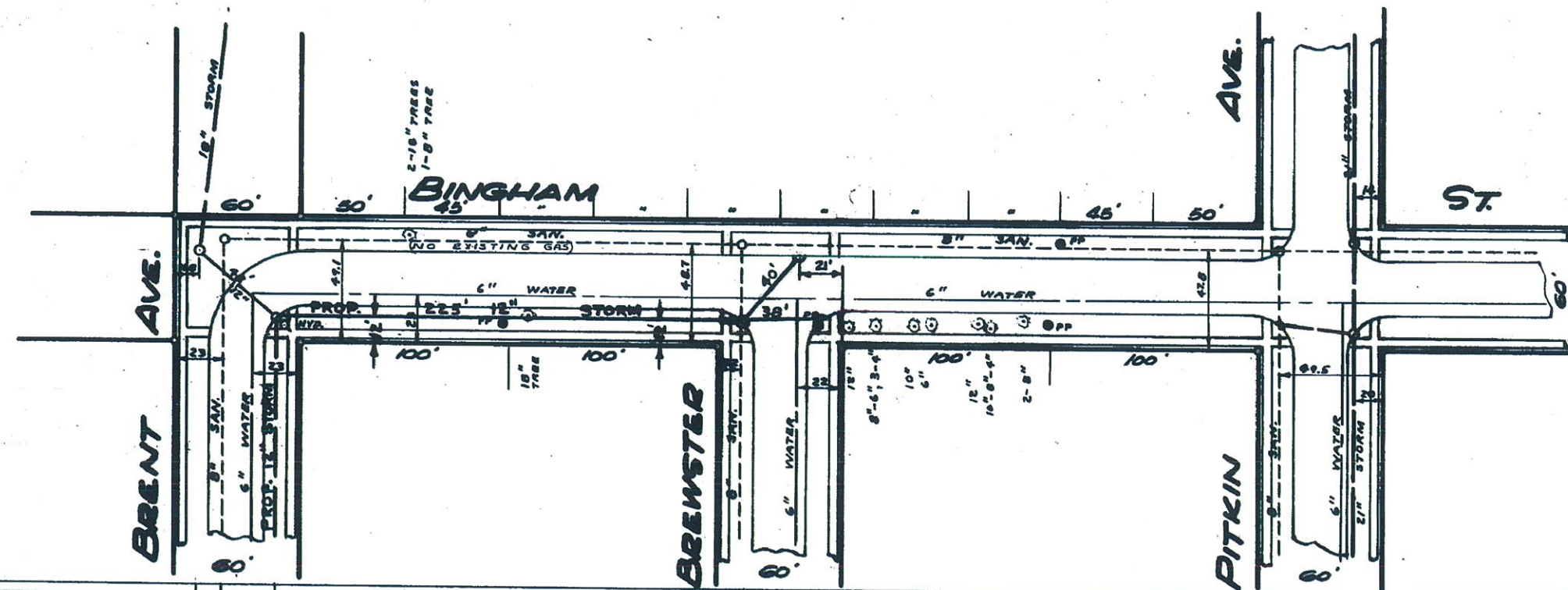

ALL SEWER CONSTRUCTION
SHALL CONFORM TO THE
LATEST CITY OF FLINT
SPECIFICATIONS.

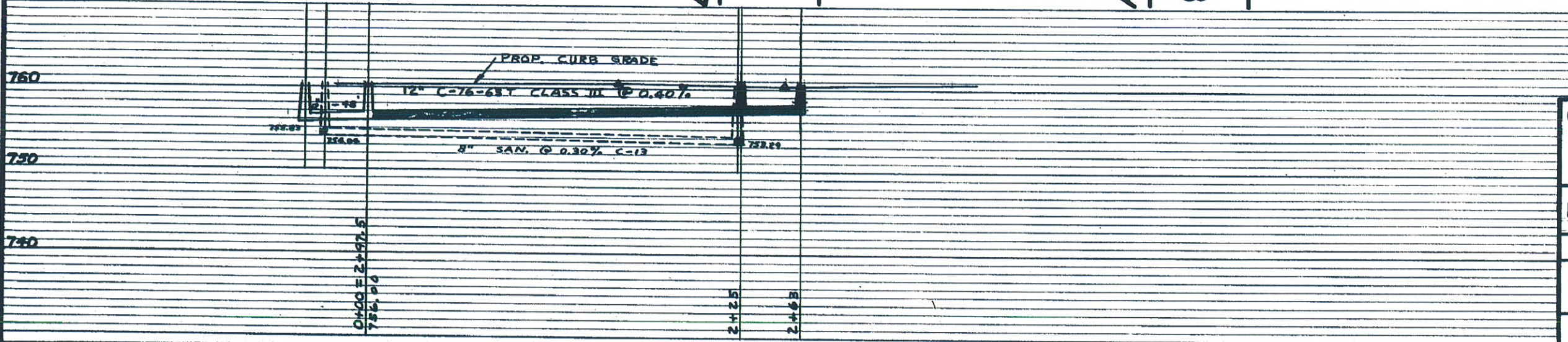

| | | | |
|--|--------------------------------|--------------------------|-------------------|
| CITY OF FLINT, MICHIGAN | | | |
| DEPARTMENT OF PUBLIC WORKS | | | |
| ENGINEERING DIVISION | | | |
| CITY MANAGER | | DIRECTOR PUBLIC WORKS | |
| PLAN AND PROFILE OF BINGHAM ST. STORM | | | |
| BRENT AVE. TO PITKIN AVE. | | | |
| SCALE: HORIZONTAL 1" = 50' | | VERTICAL 1" = 10' | |
| DRAWN BY | DATE | CHECKED BY | DATE |
| APPROVED BY THE CITY COMMISSION | | CITY CLERK | |
| DATE | APPROVED BY THE PLANNING BOARD | | SECRETARY |
| DATE | WORK DONE BY | | BOOK 1206 PAGE 41 |
| SHEET | OF | 2073 | |

D-7492

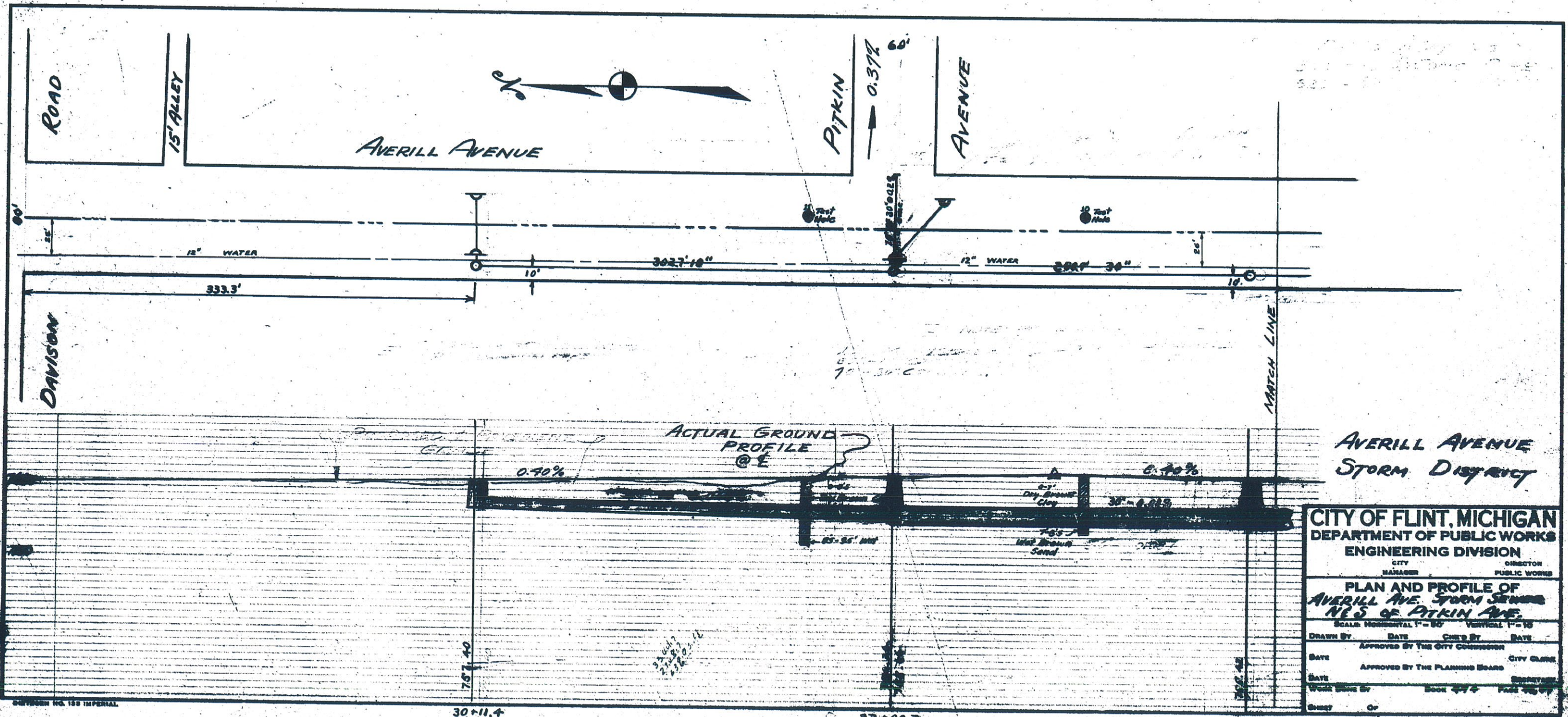

AVERILL AVENUE
STORM DISTRICT

| | | | |
|---|--------------------------------|-----------------------|------------|
| CITY OF FLINT, MICHIGAN | | | |
| DEPARTMENT OF PUBLIC WORKS | | | |
| ENGINEERING DIVISION | | | |
| CITY MANAGER | | DIRECTOR PUBLIC WORKS | |
| PLAN AND PROFILE OF AVERILL AVE. STORM SEWERS N.E.S. OF PITKIN AVE. | | | |
| SCALE HORIZONTAL 1" = 50' | | VERTICAL 1" = 10' | |
| DRAWN BY | DATE | CHECKED BY | DATE |
| APPROVED BY THE CITY COMMISSION | | | |
| DATE | APPROVED BY THE PLANNING BOARD | | CITY CLERK |
| DATE | APPROVED BY THE PLANNING BOARD | | SECRETARY |
| WORK DONE BY | BOOK 474 | PAGE 70 OF 77 | |
| SHEET | OF | | |

D-7492

D-7493

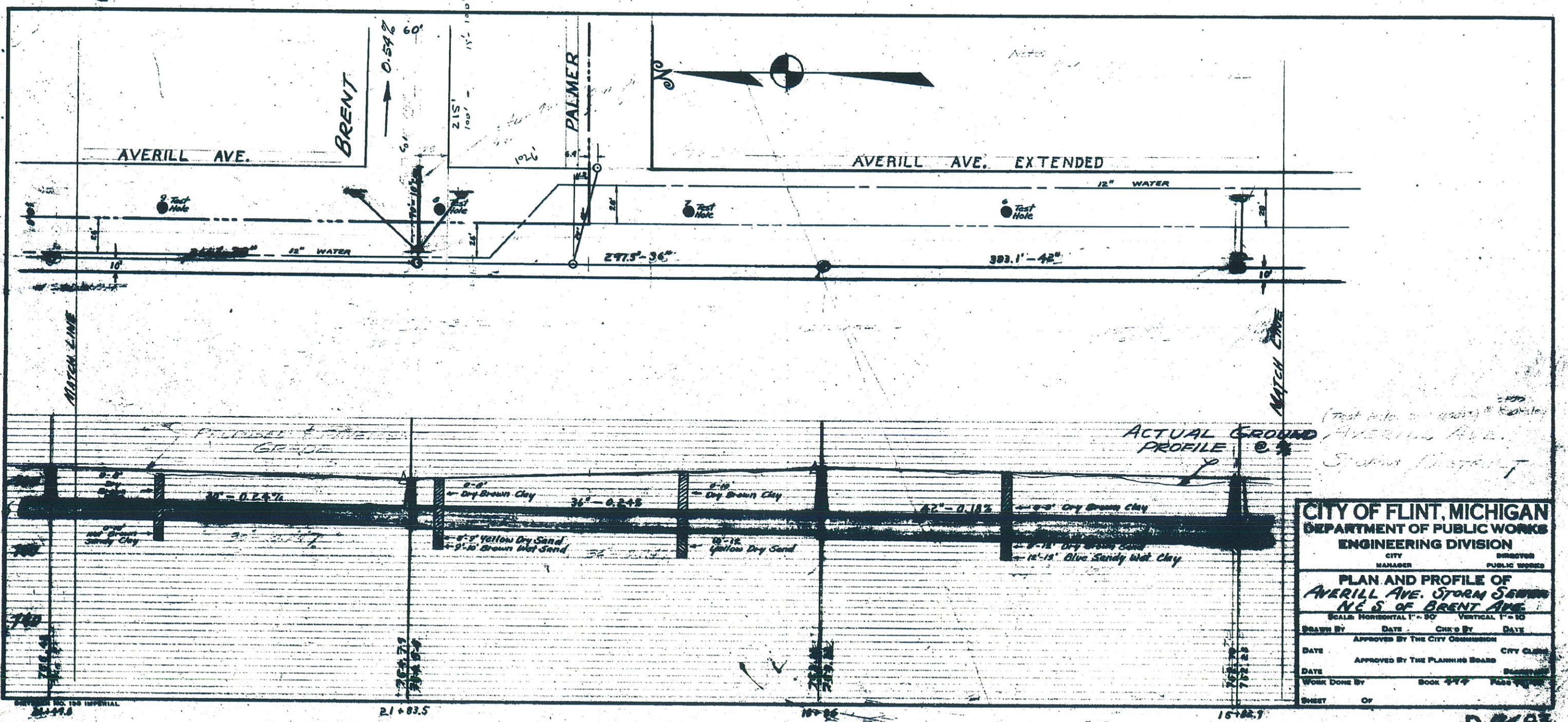

| | | | |
|-----------------------------------|--------------------------------|-------------------|-------------------|
| CITY OF FLINT, MICHIGAN | | | |
| DEPARTMENT OF PUBLIC WORKS | | | |
| ENGINEERING DIVISION | | DIRECTOR | |
| CITY MANAGER | | PUBLIC WORKS | |
| PLAN AND PROFILE OF | | | |
| AVERILL AVE. STORM SEWER | | | |
| N.E.S. OF BRENT AVE. | | | |
| SCALE: HORIZONTAL 1" = 50' | | VERTICAL 1" = 10' | |
| DRAWN BY | DATE | CHECKED BY | DATE |
| APPROVED BY THE CITY COMMISSION | | | |
| DATE | APPROVED BY THE PLANNING BOARD | | CITY CLERK |
| DATE | WORK DONE BY | | BOOK 444 PAGE 100 |
| SHEET OF | | | |

D-7493

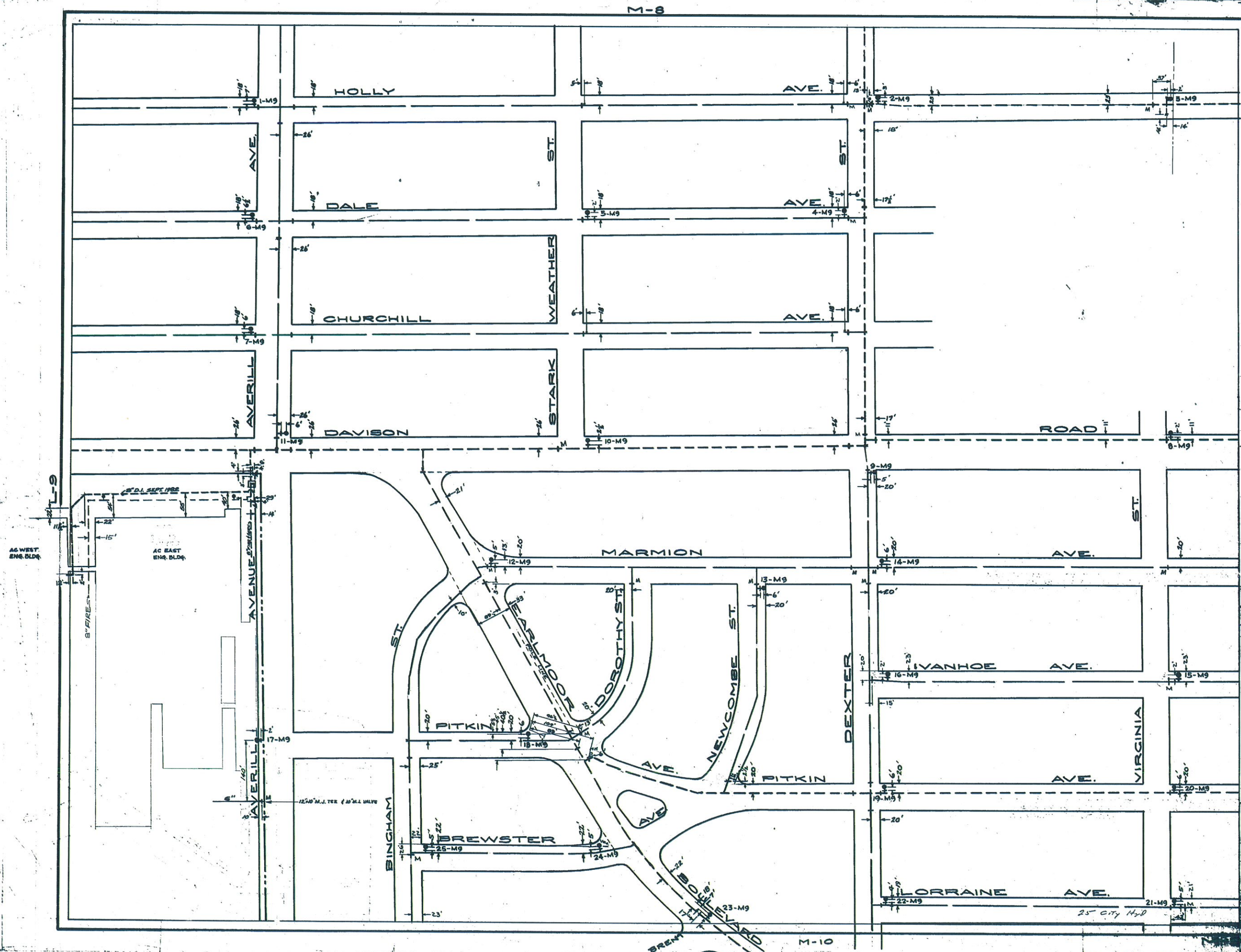

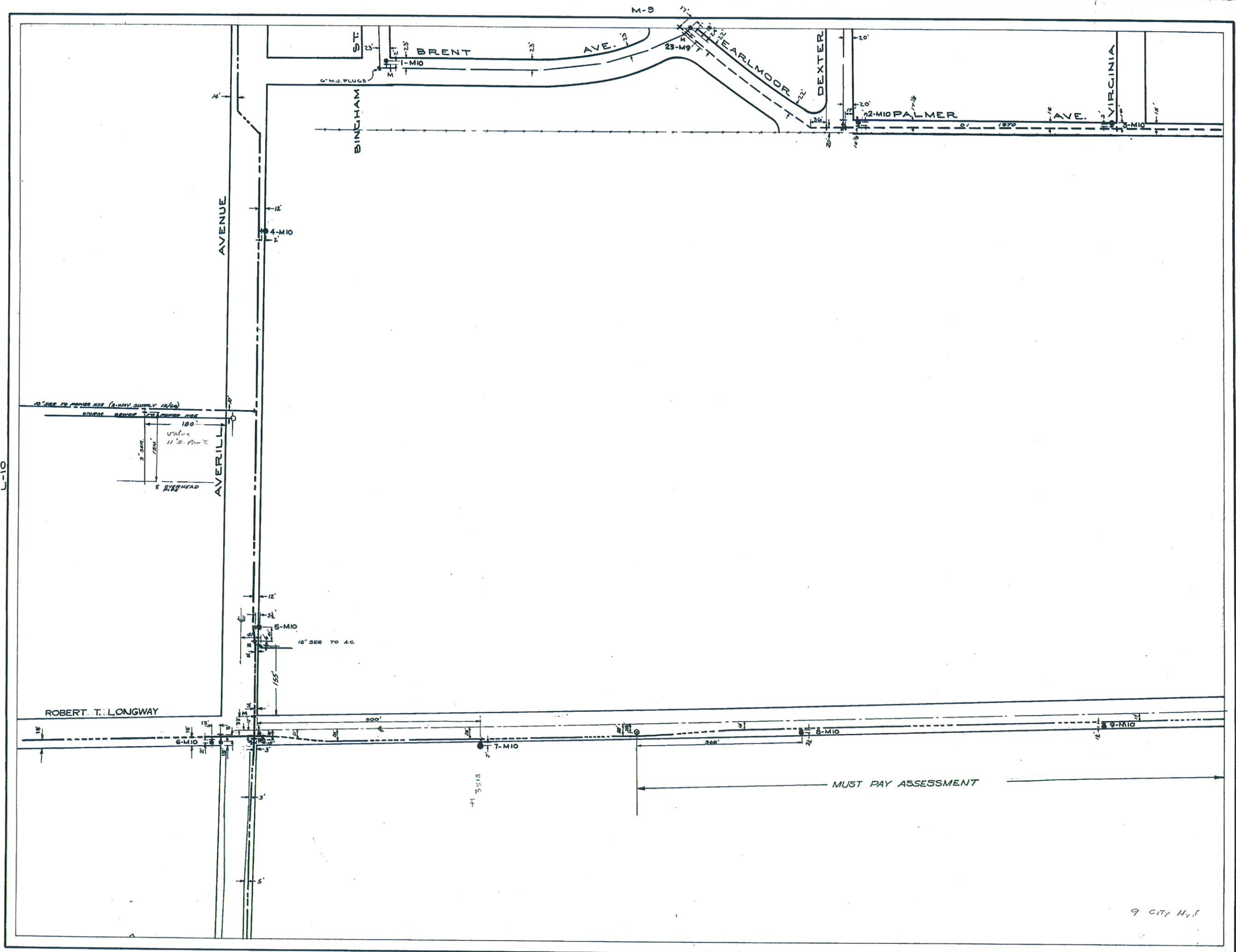

L-10

0-1-2

M-11

M-10

9 CITY H.Y.F.



L10

ROBERT T. LONGWAY

BLVD.

BLVD.

14' E. of curb

15' E. of curb

15' E. of curb

15' E. of curb

15' E. of curb

15' E. of curb

15' E. of curb

15' E. of curb

15' E. of curb

15' E. of curb

15' E. of curb

MUST PAY
ASSESSMENT

M11

M10

AVE

BINGHAM AVE

BREWSTER AVE

BRENT AVE

EARL MOOR

BLVD.

DEXTER ST

PITKIN

LORRAINE

PALMER

VIRGINIA ST.

AVE

AVE

AVE

N10

FORMER DELPHI FLINT
EAST OPERATIONS

NORTH AVERILL AVENUE

SUNSHINE DRIVE

PITKIN AVENUE

JASON DRIVE

BINGHAM STREET

BRENT AVENUE

BREWSTER AVENUE

LEGEND

- PROPERTY LINE
- SITE BUILDING
- TRAILER
- TRANSFORMER PAD
- ALTERNATE A

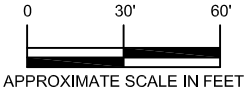

General Notes:

- Perform all Work in accordance with Contract Documents/Specifications, Federal, State and Local rules and regulations.
- Obtain all permits, waivers, clearances, inspections etc.
- Submit all notifications, applications, plans, documentation, etc.
- Install SESC measures.
- Abate all asbestos containing materials.
- Demolish all buildings, mobile homes/trailers, trailer pads, roads (Sunshine and Jason Drives) and improvemets.
- Remove, containerize, characterize, transport, and dispose of all wastes materials.
- Protect Site tree's greater than 5" in diameter.
- Protect structures, improvements, and vegetation on all adjacent Public and Private properties, repair at no cost to Owner.
- Cut and Cap gas, electric, water and sanitary sewers at mains in accordance with City requirements.
- Protect Site storm water catch basins and associated sewer lines.
- Strip, screen and stockpile topsoil for reuse at Site.
- Place and compact owner approved backfill to 6" below grade.
- Rough Grade to match adjacent grades, slope towards existing storm drains/catch basins to prevent ponding.
- Place 6" owner approved, screened topsoil to Final Grade, seed, mulch and water.
- Abatement of Burned/Unsafe structures: Abate accessible ACM, then demolish, containerize, transport and dispose of burned/unsafe structures. All work to be completed by Michigan Licensed Abatement Contractor, utilizing Accredited Abatement Workers in strict accordance with EPA NESHAPs and OSHA requirements including, but not limited to: structures/debris adequately wetted to prevent visible emissions, debris placed in leak proof containers, properly transported and disposed.

Keyed Demolition Notes:

- 1 Abate asbestos and other Hazardous/regulated materials, demolish buildings and trailers
- 2 Remove former transformer pads
- 3 Remove Site roads (Sunshine and Jason Drives).
- 4 Protect private property, structures, improvements, and vegetation



46555 HUMBOLDT DRIVE, SUITE 100
NOVI, MI 48377
PH: 248-669-5140
FAX: 248-669-5147
EMAIL: WWW.ATCGROUPSERVICES.COM

DATE:
4/16/18

DRAWN BY:
LJH

REVIEWED BY:
MG

PROJECT NO.:
188BS18148

SCALE:
1" = 60'

FIGURE 1

SITE MAP (Revised)

1518 NORTH AVERIL AVENUE
FLINT, MICHIGAN

PRE-BID WALKTHROUGH LB#18-007

Request for Proposals - Environmental Abatement, Demolition and Restoration of 1518 Averill Ave

Thursday, April 12, 2018

| NAME | COMPANY name and address | TELEPHONE NUMBER | EMAIL ADDRESS | If you are entering the premises and any associated structures please affirm that you have read the notice at the bottom of this page and you are entering at your own risk. |
|-----------------|------------------------------------|------------------|---------------------------|--|
| John Fowler | Sablen Pave Inc | 734-5293873 | | Yes |
| Scott Moritz | E T MacKenzie | 517-622-2143 | smoritz@mackenzieco.com | Yes |
| Don Malus | Melching Demolition | 989 992-3978 | DonMalus@melchingdemo.com | Yes |
| GAGE CUPPETELLI | NORTH AMERICAN DISMANTLING (NADCL) | 810-267-4058 | gcuppetelli@NADCL.com | Yes |
| Tim Henrich | Henrich | 734-770-9165 | Tim@henrich.com | Yes |
| John Sears | Sc Env | 517-202-1666 | John@ScEnv.com | Yes |
| Joe Smalley | Smalley Co | 844 757 1200 | Joe@SmalleyCo.com | Yes |



Site Walk Safety Notice:

Note that hazardous conditions may exist at the subject property. Bidders are not required to enter and of the structures on site. If choose to do so, Bidder shall enter structures on the subject property at their own risk. Structures on subject property have been abandoned for years. Potential hazards present at the property include, but are not limited to: standing water, falling debris, asbestos, mold, unlighted areas, and trip hazards. At a minimum, hard hats, non-slip boots, and flashlights are required for those entering structures on the subject property.

PRE-BID WALKTHROUGH LB#18-007

Request for Proposals - Environmental Abatement, Demolition and Restoration of 1518 Averill Ave

Thursday, April 12, 2018

| NAME | COMPANY name and address | TELEPHONE NUMBER | EMAIL ADDRESS | If you are entering the premises and any associated structures please affirm that you have read the notice at the bottom of this page and you are entering at your own risk. |
|----------------|--------------------------|------------------|-------------------------|--|
| Quint LeHar | L. LeHar + Sons Etc | 810 732-5776 | quint@lehar.com |  |
| MARTIN BURRASH | BURRASH WRECKING, INC | 742-9500 | BURRASHWRECKING@AOL.COM |  |
| Felix Finholm | GLBA | | | |
| Martin Gamble | ATC | | | |
| Brandon | ATC | | | |
| | | | | |
| | | | | |

Site Walk Safety Notice:
 Note that hazardous conditions may exist at the subject property. Bidders are not required to enter and of the structures on site. If choose to do so, Bidder shall enter structures on the subject property at their own risk. Structures on subject property have been abandoned for years. Potential hazards present at the property include, but are not limited to: standing water, falling debris, asbestos, mold, unlighted areas, and trip hazards. At a minimum, hard hats, non-slip boots, and flashlights are required for those entering structures on the subject property.

ATTACHMENT 2

2018 Prevailing Wage Rates for State Funded Projects**Unofficial Rates For Informational Purposes Only****Genesee County**

Page 1 of 25

| <u>Classification</u> | | Straight Hourly | Time and a Half | Double Time | Overtime Provision |
|---|-------------------------------------|--------------------|--------------------|----------------|--------------------|
| Name | Description | | | | |
| Asbestos & Lead Abatement Laborer | | | | | |
| Asbestos & Lead Abatement Laborer | MLDC | \$41.30 | \$55.23 | \$69.16 | H H H X X X D Y |
| Comment | | | | | |
| 4 ten hour days @ straight time allowed Monday-Saturday, must be consecutive calendar days | | | | | |
| Apprentice Rates: | | | | | |
| | Trainee 600 hours + 1 calendar year | \$30.22 | \$33.28 | \$41.73 | |
| Asbestos, Lead and Mold Abatement, Hazardous Material Handler | | | | | |
| Asbestos, Lead and Mold Abatement, Hazardous Material Handler | AS207 | \$40.75 | \$54.25 | \$67.75 | H H H X X X D Y |
| Comment | | | | | |
| Four ten hour days @ straight time allowed Monday-Saturday, must be consecutive calendar days | | | | | |
| Boilermaker | | | | | |
| Boilermaker | BO169 | \$54.70 | \$81.08 | \$107.45 | H H H H H H D Y |
| Apprentice Rates: | | | | | |
| | 1st 6 months | \$40.31 | \$59.49 | \$78.67 | |
| | 2nd 6 months | \$41.45 | \$61.21 | \$80.95 | |
| | 3rd 6 months | \$42.57 | \$62.88 | \$83.19 | |
| | 4th 6 months | \$43.69 | \$64.57 | \$85.43 | |
| | 5th 6 months | \$44.81 | \$66.24 | \$87.67 | |
| | 6th 6 months | \$48.63 | \$72.50 | \$96.36 | |
| | 7th 6 months | \$49.32 | \$73.01 | \$96.69 | |
| | 8th 6 months | \$51.58 | \$76.40 | \$101.21 | |

Unofficial Rates For Informational Purposes Only

Genesee County

Page 2 of 25

| <u>Classification</u> | | Straight Hourly | Time and a Half | Double Time | Overtime Provision |
|--|--|--------------------|--------------------|----------------|--------------------|
| Name | Description | | | | |
| Bricklayer | | | | | |
| Bricklayer and Block | BR9-12-BL | \$49.69 | \$63.74 | \$77.80 | H H H H H H D Y |
| Comment | Make up day allowed 4 10s allowed M-F; Saturday make up day | | | | |
| | Apprentice Rates: | | | | |
| | 0 - 749 hours | \$37.45 | \$45.68 | \$53.92 | |
| | 750 - 1,499 hours | \$38.98 | \$47.98 | \$56.98 | |
| | 1,500 - 2,249 hours | \$40.51 | \$50.27 | \$60.04 | |
| | 2,250 - 2,999 hours | \$42.04 | \$52.56 | \$63.10 | |
| | 3,000 - 3,749 hours | \$43.57 | \$54.86 | \$66.16 | |
| | 3,750 - 4,499 hours | \$45.10 | \$57.16 | \$69.22 | |
| | 4,500 - 5,249 hours | \$46.63 | \$59.45 | \$72.28 | |
| | 5,250 - 6,000 hours | \$48.16 | \$61.74 | \$75.34 | |
| Stone Mason, Artificial Masonry, Marble Masonry, and Pointing, Cleaning and Caulking | BR9-12-S | \$49.69 | \$63.74 | \$77.80 | H H H H H H D Y |
| Comment | 4 10s allowed M-F | | | | |
| | Apprentice Rates: | | | | |
| | 0-749 hours | \$38.98 | \$47.98 | \$56.98 | |
| | 750-1499 hours | \$40.51 | \$50.27 | \$60.04 | |
| | 1500-2249 hours | \$42.04 | \$52.56 | \$63.10 | |
| | 2250-2999 hours | \$43.57 | \$54.86 | \$66.16 | |
| | 3000-3749 hours | \$45.10 | \$57.16 | \$69.22 | |
| | 3750-4499 hours | \$46.63 | \$59.45 | \$72.28 | |
| Carpenter | | | | | |
| Carpet and Resilient Floor Layer, (does not include installation of prefabricated formica & parquet flooring which is to be paid carpenter rate) | CA1045 | \$51.94 | \$73.28 | \$94.62 | X X H X X X D Y |
| | Apprentice Rates: | | | | |
| | 1st 6 months | \$25.87 | \$34.92 | \$43.98 | |
| | 2nd 6 months | \$29.86 | \$40.92 | \$51.96 | |
| | 3rd 6 months | \$32.07 | \$44.23 | \$56.38 | |
| | 4th 6 months | \$34.27 | \$47.52 | \$60.78 | |
| | 5th 6 months | \$36.47 | \$50.83 | \$65.18 | |
| | 6th 6 months | \$38.69 | \$54.16 | \$69.62 | |
| | 7th 6 months | \$40.90 | \$57.48 | \$74.04 | |
| | 8th 6 months | \$43.10 | \$60.77 | \$78.44 | |

Unofficial Rates For Informational Purposes Only

County: Genesee

zz alpha web rates

Date Rendered: 4/2/2018

Genesee County

Page 3 of 25

| <u>Classification</u> | | Straight Hourly | Time and a Half | Double Time | Overtime Provision |
|--|------------------------|--------------------|--------------------|----------------|--------------------|
| Name | Description | | | | |
| Carpenter, Acoustical Ceiling Tile Erector, Piledriver | CA706F | \$46.05 | \$58.93 | \$71.81 | X X H H H H H D N |
| Apprentice Rates: | | | | | |
| | 1st year | \$38.32 | \$47.34 | \$56.35 | |
| | 2nd year | \$39.61 | \$49.27 | \$58.93 | |
| | 3rd year | \$42.19 | \$53.14 | \$64.09 | |
| | 4th year | \$44.76 | \$57.00 | \$69.23 | |
| Cement Finisher | | | | | |
| Cement Finisher | BR9-12-CF | \$44.02 | \$56.73 | \$69.43 | X X H X X X H D Y |
| Comment 4 10s allowed M-F | | | | | |
| Apprentice Rates: | | | | | |
| | 0-749 hours | \$34.36 | \$42.49 | \$50.64 | |
| | 750-1499 hours | \$35.74 | \$44.57 | \$53.40 | |
| | 1500-2249 hours | \$37.12 | \$46.63 | \$56.16 | |
| | 2250-2999 hours | \$38.50 | \$48.71 | \$58.92 | |
| | 3000-3749 hours | \$39.88 | \$50.77 | \$61.68 | |
| | 3750-4499 hours | \$41.26 | \$52.85 | \$64.44 | |
| Cement Mason | | | | | |
| Cement Mason | PL16-6 | \$41.92 | \$55.93 | \$69.94 | H H H H H H H D Y |
| Comment Make up day allowed | | | | | |
| Four 10s allowed Monday-Thursday with Friday or Saturday inclement weather make up days. Saturday hours for inclement weather make up shall be paid straight rate unless over 40 hours worked. | | | | | |
| Apprentice Rates: | | | | | |
| | 1st year | \$32.11 | \$41.22 | \$50.32 | |
| | 2nd year | \$34.92 | \$45.43 | \$55.94 | |
| | 3rd year | \$37.72 | \$49.63 | \$61.54 | |
| Drywall | | | | | |
| Finisher-hand finishing | PT-1052-DF | \$37.97 | \$50.98 | \$63.99 | X X H X X X H D Y |
| Comment Make up day allowed | | | | | |
| The regular weekly work schedule may consist of 4 10s on consecutive days, Monday thru Saturday. A make-up day may be scheduled for work missed due to holiday or inclement weather. | | | | | |
| Apprentice Rates: | | | | | |
| | 1st year | \$24.96 | \$31.47 | \$37.97 | |
| | 2nd year, 1st 6 months | \$27.56 | \$35.37 | \$43.17 | |
| | 2nd year, 2nd 6 months | \$30.16 | \$39.27 | \$48.37 | |
| | 3rd year, 1st 6 months | \$32.77 | \$43.18 | \$53.59 | |
| | Until completion | \$35.37 | \$47.08 | \$58.79 | |

Unofficial Rates For Informational Purposes Only

County: Genesee

zz alpha web rates

Date Rendered: 4/2/2018

Genesee County

Page 4 of 25

| <u>Classification</u> | | | | | | |
|---|-------------------|--|--------------------|--------------------|----------------|--------------------|
| Name | Description | | Straight Hourly | Time and a Half | Double Time | Overtime Provision |
| Electrician | | | | | | |
| Journeyman Electrician -Inside Wireman | EC-948-IW | | \$57.91 | \$82.96 | \$108.01 | H H H H H H D Y |
| | Apprentice Rates: | | | | | |
| | 1st period | | \$23.43 | \$32.12 | \$40.80 | |
| | 2nd period | | \$25.62 | \$35.41 | \$45.18 | |
| | 3rd period | | \$27.63 | \$38.49 | \$49.35 | |
| | 4th period | | \$31.97 | \$45.00 | \$58.03 | |
| | 5th period | | \$34.14 | \$48.26 | \$62.37 | |
| | 6th period | | \$38.50 | \$54.79 | \$71.09 | |
| Sound and Communication Installer/Technician | EC-948-SC | | \$42.76 | \$60.44 | \$78.11 | H H H H H H D Y |
| Comment | | | | | | |
| Four 10s may be worked Monday-Thursday or Tuesday-Friday. | | | | | | |
| | Apprentice Rates: | | | | | |
| | 1st year | | \$15.44 | \$21.90 | \$28.37 | |
| | 2nd year | | \$16.87 | \$24.05 | \$31.23 | |
| | 3rd year | | \$21.02 | \$30.45 | \$39.88 | |
| | 4th year | | \$24.15 | \$35.70 | \$46.88 | |
| Elevator Constructor | | | | | | |
| Elevator Constructor Mechanic | EL-85 | | \$70.77 | | \$116.32 | D D D D D D D Y |
| Comment | | | | | | |
| 4 tens allowed M-TH | | | | | | |
| | Apprentice Rates: | | | | | |
| | 1st year | | \$50.27 | | \$75.32 | |
| | 2nd year | | \$54.83 | | \$84.44 | |
| | 3rd year | | \$57.10 | | \$88.98 | |
| | 4th year | | \$61.66 | | \$98.10 | |

Unofficial Rates For Informational Purposes Only

County: Genesee

zz alpha web rates

Date Rendered: 4/2/2018

Genesee County

Page 5 of 25

| <u>Classification</u> | | Straight Hourly | Time and a Half | Double Time | Overtime Provision |
|--|---|--------------------|--------------------|----------------|--------------------|
| Name | Description | | | | |
| Glazier | | | | | |
| Glazier | GL-826 | \$44.78 | \$60.87 | \$76.95 | H H H H H H D Y |
| Comment | 4 tens allowed on consecutive days | | | | |
| | Apprentice Rates: | | | | |
| | 1st 6 months | \$31.91 | \$41.57 | \$51.21 | |
| | 2nd 6 months | \$33.52 | \$43.98 | \$54.43 | |
| | 3rd 6 months | \$35.12 | \$46.38 | \$57.63 | |
| | 4th 6 months | \$36.74 | \$48.81 | \$60.87 | |
| | 5th 6 months | \$38.35 | \$51.22 | \$64.09 | |
| | 6th 6 months | \$39.96 | \$53.64 | \$67.31 | |
| | 7th 6 months | \$41.57 | \$56.05 | \$70.53 | |
| | 8th 6 months | \$43.17 | \$58.45 | \$73.73 | |
| Heat and Frost Insulator | | | | | |
| Spray Insulation - Qualified Senior Sprayer, application of all products | AS25S | \$29.04 | \$42.35 | | X X X H H H H H N |
| Heat and Frost Insulator and Asbestos Worker | | | | | |
| Heat and Frost Insulator and Asbestos Worker | AS47 | \$47.75 | \$63.01 | \$78.27 | H H H H H H D Y |
| Comment | Make up day allowed | | | | |
| | Friday for cancelled work in a four 10 hour schedule | | | | |
| | Apprentice Rates: | | | | |
| | 1st year | \$27.88 | \$35.51 | \$43.14 | |
| | 2nd year | \$31.85 | \$41.00 | \$50.16 | |
| | 3rd year | \$35.82 | \$46.50 | \$57.18 | |
| | 4th year | \$39.80 | \$52.01 | \$64.22 | |
| | 5th year | \$43.78 | \$57.51 | \$71.25 | |
| Ironworker | | | | | |
| Fence, Sound Barrier & Guardrail erection/installation and Exterior Signage work | IR-25-F1 | \$35.95 | \$48.05 | \$60.15 | X X H X X X H D Y |
| Comment | Four ten hour work days may be worked during Monday-Saturday. | | | | |
| | Apprentice Rates: | | | | |
| | 60% Level | \$25.39 | \$32.65 | \$39.91 | |
| | 65% Level | \$26.71 | \$34.58 | \$42.44 | |
| | 70% Level | \$28.03 | \$36.51 | \$44.98 | |
| | 75% Level | \$29.35 | \$38.42 | \$47.50 | |
| | 80% Level | \$30.67 | \$40.35 | \$50.03 | |
| | 85% Level | \$31.99 | \$42.28 | \$52.56 | |

Unofficial Rates For Informational Purposes Only

County: Genesee

zz alpha web rates

Date Rendered: 4/2/2018

Genesee County

Page 6 of 25

| <u>Classification</u> | | Straight Hourly | Time and a Half | Double Time | Overtime Provision |
|-------------------------------|---|--------------------|--------------------|----------------|--------------------|
| Name | Description | | | | |
| Siding, Glazing, Curtain Wall | IR-25-GZ2 | \$48.13 | \$59.92 | \$71.70 | X X H H H H D D Y |
| Comment | Make up day allowed Friday, 4 tens may be worked Monday thru Thursday @ straight time. | | | | |
| | Apprentice Rates: | | | | |
| | Level 1 | \$31.20 | \$37.93 | \$44.65 | |
| | Level 2 | \$33.31 | \$40.67 | \$48.02 | |
| | Level 3 | \$35.42 | \$43.41 | \$51.39 | |
| | Level 4 | \$37.54 | \$46.16 | \$54.77 | |
| | Level 5 | \$39.66 | \$48.92 | \$58.17 | |
| | Level 6 | \$41.78 | \$51.67 | \$61.55 | |
| Pre-engineered Metal Work | IR-25-PE-Z1 | \$48.09 | \$58.86 | \$69.63 | X X H X X X X D Y |
| Comment | Make up day allowed 4 tens allowed M-Th with Saturday make up day | | | | |
| | Apprentice Rates: | | | | |
| | Probation 1st Year | \$26.83 | \$32.03 | \$37.23 | |
| | 1st Level | \$28.96 | \$34.92 | \$40.88 | |
| | 2nd Level | \$28.96 | \$34.92 | \$40.88 | |
| | 3rd Level | \$31.08 | \$37.79 | \$44.50 | |
| | 4th Level | \$33.21 | \$40.68 | \$48.15 | |
| | 5th Level | \$35.33 | \$43.55 | \$51.77 | |
| | 6th Level | \$37.46 | \$46.43 | \$55.41 | |
| Reinforced Iron Work | IR-25-RF | \$57.30 | \$85.66 | \$114.02 | H H D H D D D D N |
| Make up day allowed | | | | | |
| | Apprentice Rates: | | | | |
| | Level 1 | \$40.32 | \$59.89 | \$79.46 | |
| | Level 2 | \$42.68 | \$63.43 | \$84.18 | |
| | Level 3 | \$45.22 | \$67.24 | \$89.26 | |
| | Level 4 | \$47.75 | \$71.04 | \$94.32 | |
| | Level 5 | \$50.29 | \$74.84 | \$99.40 | |
| | Level 6 | \$50.29 | \$74.84 | \$99.40 | |
| Rigging Work | IR-25-RIG | \$63.51 | \$95.00 | \$126.49 | H H H H H H D N |
| | Apprentice Rates: | | | | |
| | Level 1 & 2 | \$38.22 | \$56.16 | \$74.85 | |
| | Level 3 | \$41.05 | \$61.54 | \$82.01 | |
| | Level 4 | \$43.87 | \$65.76 | \$87.65 | |
| | Level 5 | \$46.70 | \$70.01 | \$93.31 | |
| | Level 6 | \$49.53 | \$74.25 | \$98.97 | |

Unofficial Rates For Informational Purposes Only

County: Genesee

zz alpha web rates

Date Rendered: 4/2/2018

Genesee County

Page 7 of 25

| <u>Classification</u> | | Straight | Time and | Double | |
|---|---|----------|----------|----------|--------------------|
| Name | Description | Hourly | a Half | Time | Overtime Provision |
| Decking | IR-25-SD | \$55.47 | \$82.87 | \$110.26 | X X H H H H D D Y |
| Comment | Make up day allowed 4 tens may be worked Monday thru Thursday @ straight time. If bad weather, Friday may be a make up day. If holiday celebrated on a Monday, 4 10s may be worked Tuesday thru Friday. Work in excess of 12 hours per day must be paid @ double time. | | | | |
| Structural, ornamental, welder and pre-cast | IR-25-STR | \$63.64 | \$95.12 | \$126.60 | H H H H H H D D Y |
| Comment | Make up day allowed 4 tens may be worked Monday thru Thursday @ straight time. If bad weather, Friday may be a make up day. If holiday celebrated on a Monday, 4 10s may be worked Tuesday thru Friday. Work in excess of 12 hours per day must be paid @ double time. | | | | |
| | Apprentice Rates: | | | | |
| | Levels 1 & 2 | \$38.22 | \$56.99 | \$75.75 | |
| | Level 3 | \$41.05 | \$61.24 | \$81.41 | |
| | Level 4 | \$43.87 | \$65.46 | \$87.05 | |
| | Level 5 | \$46.70 | \$69.71 | \$92.71 | |
| | Level 6 | \$49.53 | \$73.95 | \$98.37 | |
| | Level 7 | \$52.35 | \$78.18 | \$104.01 | |
| | Level 8 | \$55.18 | \$82.43 | \$109.67 | |
| Industrial Door erection & construction | IR-25-STR-D | \$43.74 | \$65.27 | \$86.80 | H H H H H H D D Y |
| Comment | Make up day allowed Friday for bad weather when 4 tens scheduled for M-Th. If holiday celebrated on M, 4 tens may be worked T-F. Work in excess of 12 hours per day must be paid @ double time. | | | | |
| Laborer | | | | | |
| Carpenter tender, mason tender, cement finisher tender, plasterer tender, signal man & top man (sewer work), watchman, tunnel mucker, jackhammer & air spade operator, tunnel man (concrete shoveler, car pusher) bottom man (sewer work), windlass operator (caisson work), demolition laborer, mortar mixer, air, electric, gas tool operator, pump operator (all 3" pumps and below), air & electric bush hammers, concrete gas buggy, concrete saw operator, crock and pipe layers (conduit & vitrified tile, except 4" drain tile around buildings), & Caisson work inside building. | L1075 | \$36.26 | \$47.57 | \$58.87 | X X H H H H D D Y |
| Comment | Make up day allowed Saturday | | | | |
| | Apprentice Rates: | | | | |
| | 0-1,000 work hours | \$30.61 | \$39.09 | \$47.57 | |
| | 1,001-2,000 work hours | \$31.74 | \$40.79 | \$49.83 | |
| | 2,001-3,000 work hours | \$32.87 | \$42.48 | \$52.09 | |
| | 3,001-4,000 work hours | \$35.13 | \$45.87 | \$56.61 | |

Unofficial Rates For Informational Purposes Only

County: Genesee

zz alpha web rates

Date Rendered: 4/2/2018

Genesee County

Page 8 of 25

| <u>Classification</u> | | Straight Hourly | Time and a Half | Double Time | Overtime Provision |
|--|---|--------------------|--------------------|----------------|--------------------|
| Name | Description | | | | |
| Cleaner/Sweeper | L1075-CLN | \$27.22 | \$34.29 | \$41.35 | X X H H H H D Y |
| Comment | Make up day allowed Saturday | | | | |
| Laborer - Hazardous | | | | | |
| Class A Laborer - performing work in conjunction with site preparation and other preliminary work prior to actual removal, handling, or containment of hazardous waste substances not requiring use of personal protective equipment required by state or federal regulations; or a laborer performing work in conjunction with the removal, handling, or containment of hazardous waste substances when use of personal protective equipment level "D" is required. | LHAZ-Z7-A | \$36.26 | \$51.35 | \$66.43 | H H H H H H D Y |
| Comment | Make up day allowed 4 10s allowed M-Th or T-F; inclement weather makeup day Friday | | | | |
| Apprentice Rates: | | | | | |
| 0-1,000 work hours | | \$30.61 | \$42.87 | \$55.13 | |
| 1,001-2,000 work hours | | \$31.74 | \$44.57 | \$57.39 | |
| 2,001-3,000 work hours | | \$32.87 | \$46.26 | \$59.65 | |
| 3,001-4,000 work hours | | \$35.13 | \$49.65 | \$64.17 | |
| Class B Laborer - performing work in conjunction with the removal, handling, or containment of hazardous waste substances when the use of personal protective equipment levels "A", "B" or "C" is required. | LHAZ-Z7-B | \$37.26 | \$52.85 | \$68.43 | H H H H H H D Y |
| Comment | Make up day allowed 4 10s allowed M-Th or T-F; inclement weather makeup day Friday | | | | |
| Apprentice Rates: | | | | | |
| 0-1,000 work hours | | \$31.36 | \$43.99 | \$56.63 | |
| 1,001-2,000 work hours | | \$32.54 | \$45.77 | \$58.99 | |
| 2,001-3,000 work hours | | \$33.72 | \$47.53 | \$61.35 | |
| 3,001-4,000 work hours | | \$36.08 | \$51.07 | \$66.07 | |
| Laborer Underground - Open Cut, Class VI | | | | | |
| Grouting man, top man assistant, audio visual television operations and all other operations in connection with closed circuit television inspection, pipe cleaning and pipe relining work and the installation & repair of water service pipe & appurtenances | LAUC-Z3-6 | \$32.51 | \$42.19 | \$51.85 | X X X X X X D Y |
| Apprentice Rates: | | | | | |
| 0-1,000 work hours | | \$28.39 | \$36.01 | \$43.61 | |
| 1,001-2,000 work hours | | \$29.21 | \$37.23 | \$45.25 | |
| 2,001-3,000 work hours | | \$30.04 | \$38.48 | \$46.91 | |
| 3,001-4,000 work hours | | \$31.69 | \$40.95 | \$50.21 | |

Unofficial Rates For Informational Purposes Only

County: Genesee

zz alpha web rates

Date Rendered: 4/2/2018

Genesee County

Page 9 of 25

| <u>Classification</u> | | Straight Hourly | Time and a Half | Double Time | Overtime Provision |
|--|------------------------|--------------------|--------------------|----------------|--------------------|
| Name | Description | | | | |
| Laborer Underground - Open Cut, Class I | | | | | |
| Construction Laborer | LAUC-Z3-1 | \$34.76 | \$45.56 | \$56.35 | X X X X X X D Y |
| Apprentice Rates: | | | | | |
| | 0-1,000 work hours | \$30.08 | \$38.54 | \$46.99 | |
| | 1,001-2,000 work hours | \$31.01 | \$39.93 | \$48.85 | |
| | 2,001-3,000 work hours | \$31.95 | \$41.35 | \$50.73 | |
| | 3,001-4,000 work hours | \$33.82 | \$44.15 | \$54.47 | |
| Laborer Underground - Open Cut, Class II | | | | | |
| Mortar and material mixer, concrete form man, signal man, well point man, manhole, headwall and catch basin builder, guard rail builders, headwall, seawall, breakwall, dock builder and fence erector. | LAUC-Z3-2 | \$34.90 | \$45.93 | \$56.95 | X X X X X X D Y |
| Apprentice Rates: | | | | | |
| | 0-1,000 work hours | \$30.18 | \$38.85 | \$47.51 | |
| | 1,001-2,000 work hours | \$31.12 | \$40.26 | \$49.39 | |
| | 2,001-3,000 work hours | \$32.07 | \$41.69 | \$51.29 | |
| | 3,001-4,000 work hours | \$33.96 | \$44.52 | \$55.07 | |
| Laborer Underground - Open Cut, Class III | | | | | |
| Air, gasoline and electric tool operator, vibrator operator, drillers, pump man, tar kettle operator, bracers, rodger, reinforced steel or mesh man (e.g. wire mesh, steel mats, dowel bars, etc.), cement finisher, welder, pipe jacking and boring man, wagon drill and air track operator and concrete saw operator (under 40 h.p.), windlass and tugger man, and directional boring man. | LAUC-Z3-3 | \$35.02 | \$45.95 | \$56.87 | X X X X X X D Y |
| Apprentice Rates: | | | | | |
| | 0-1,000 work hours | \$30.27 | \$38.83 | \$47.37 | |
| | 1,001-2,000 work hous | \$31.22 | \$40.25 | \$49.27 | |
| | 2,001-3,000 work hours | \$32.17 | \$41.67 | \$51.17 | |
| | 3,001-4,000 work hours | \$34.07 | \$44.53 | \$54.97 | |
| Laborer Underground - Open Cut, Class IV | | | | | |
| Trench or excavating grade man. | LAUC-Z3-4 | \$35.07 | \$46.03 | \$56.97 | X X X X X X D Y |
| Apprentice Rates: | | | | | |
| | 0-1,000 work hours | \$30.31 | \$38.89 | \$47.45 | |
| | 1,001-2,000 work hours | \$31.26 | \$40.31 | \$49.35 | |
| | 2,001-3,000 work hours | \$32.21 | \$41.73 | \$51.25 | |
| | 3,001-4,000 work hours | \$34.12 | \$44.60 | \$55.07 | |

Unofficial Rates For Informational Purposes Only

County: Genesee

zz alpha web rates

Date Rendered: 4/2/2018

Genesee County

Page 10 of 25

| <u>Classification</u> | | Straight Hourly | Time and a Half | Double Time | Overtime Provision |
|---|------------------------|--------------------|--------------------|----------------|--------------------|
| Name | Description | | | | |
| Laborer Underground - Open Cut, Class V | | | | | |
| Pipe Layer | LAUC-Z3-5 | \$35.21 | \$46.24 | \$57.25 | X X X X X X D Y |
| Apprentice Rates: | | | | | |
| | 0-1,000 work hours | \$30.41 | \$39.03 | \$47.65 | |
| | 1,001-2,000 work hours | \$31.37 | \$40.47 | \$49.57 | |
| | 2,001-3,000 work hours | \$32.33 | \$41.91 | \$51.49 | |
| | 3,001-4,000 work hours | \$34.25 | \$44.79 | \$55.33 | |
| Laborer Underground - Open Cut, Class VII | | | | | |
| Restoration laborer, seeding, sodding, planting, cutting, mulching and topsoil grading and the restoration of property such as replacing mail boxes, wood chips, planter boxes, flagstones etc. | LAUC-Z3-7 | \$29.66 | \$37.91 | \$46.15 | X X X X X X D Y |
| Apprentice Rates: | | | | | |
| | 0-1,000 work hours | \$26.25 | \$32.79 | \$39.33 | |
| | 1,001-2,000 work hours | \$26.93 | \$33.81 | \$40.69 | |
| | 2,001-3,000 work hours | \$27.61 | \$34.83 | \$42.05 | |
| | 3,001-4,000 work hours | \$28.98 | \$36.89 | \$44.79 | |
| Laborer Underground - Tunnel, Shaft & Caisson | | | | | |
| Class I - Tunnel, shaft and caisson laborer, dump man, shanty man, hog house tender, testing man (on gas), and watchman. | LAUCT-Z2-1 | \$36.82 | \$48.70 | \$60.57 | X X X X X X D Y |
| Apprentice Rates: | | | | | |
| | 0-1,000 work hours | \$31.52 | \$40.75 | \$49.97 | |
| | 1,001-2,000 work hours | \$32.58 | \$42.34 | \$52.09 | |
| | 2,001-3,000 work hours | \$33.64 | \$43.93 | \$54.21 | |
| | 3,001-4,000 work hours | \$35.76 | \$47.11 | \$58.45 | |
| Class II - Manhole, headwall, catch basin builder, bricklayer tender, mortar man, material mixer, fence erector, and guard rail builder | LAUCT-Z2-2 | \$36.91 | \$48.83 | \$60.75 | X X X X X X D Y |
| Apprentice Rates: | | | | | |
| | 0-1,000 work hours | \$31.58 | \$40.84 | \$50.09 | |
| | 1,001-2,000 work hours | \$32.65 | \$42.45 | \$52.23 | |
| | 2,001-3,000 work hours | \$33.71 | \$44.03 | \$54.35 | |
| | 3,001-4,000 work hours | \$35.84 | \$47.23 | \$58.61 | |

Unofficial Rates For Informational Purposes Only

County: Genesee

zz alpha web rates

Date Rendered: 4/2/2018

Genesee County

Page 11 of 25

| <u>Classification</u> | | Straight Hourly | Time and a Half | Double Time | Overtime Provision | |
|-----------------------|--|--------------------|--------------------|----------------|--------------------|-------------------|
| Name | Description | | | | | |
| | Class III - Air tool operator (jack hammer man, bush hammer man and grinding man), first bottom man, second bottom man, cage tender, car pusher, carrier man, concrete man, concrete form man, concrete repair man, cement invert laborer, cement finisher, concrete shoveler, conveyor man, floor man, gasoline and electric tool operator, gunnite man, grout operator, welder, heading dinky man, inside lock tender, pea gravel operator, pump man, outside lock tender, scaffold man, top signal man, switch man, track man, tugger man, utility man, vibrator man, winch operator, pipe jacking man, wagon drill and air track operator and concrete saw operator (under 40 h.p.). | LAUCT-Z2-3 | \$37.01 | \$48.98 | \$60.95 | X X X X X X X D Y |
| | Apprentice Rates: | | | | | |
| | 0-1,000 work hours | | \$31.66 | \$40.96 | \$50.25 | |
| | 1,001-2,000 work hours | | \$32.73 | \$42.57 | \$52.39 | |
| | 2,001-3,000 work hours | | \$33.80 | \$44.17 | \$54.53 | |
| | 3,001-4,000 work hours | | \$35.94 | \$47.38 | \$58.81 | |
| | Class IV - Tunnel, shaft and caisson mucker, bracer man, liner plate man, long haul dinky driver and well point man. | LAUCT-Z2-4 | \$37.17 | \$49.22 | \$61.27 | X X X X X X X D Y |
| | Apprentice Rates: | | | | | |
| | 0-1,000 work hours | | \$31.78 | \$41.14 | \$50.49 | |
| | 1,001-2,000 work hours | | \$32.86 | \$42.76 | \$52.65 | |
| | 2,001-3,000 work hours | | \$33.93 | \$44.37 | \$54.79 | |
| | 3,001-4,000 work hours | | \$36.09 | \$47.61 | \$59.11 | |
| | Class V - Tunnel, shaft and caisson miner, drill runner, keyboard operator, power knife operator, reinforced steel or mesh man (e.g. wire mesh, steel mats, dowel bars) | LAUCT-Z2-5 | \$37.43 | \$49.62 | \$61.79 | X X X X X X X D Y |
| | Apprentice Rates: | | | | | |
| | 0-1,000 work hours | | \$31.97 | \$41.43 | \$50.87 | |
| | 1,001-2,000 work hours | | \$33.06 | \$43.06 | \$53.05 | |
| | 2,001-3,000 work hours | | \$34.16 | \$44.71 | \$55.25 | |
| | 3,001-4,000 work hours | | \$36.34 | \$47.98 | \$59.61 | |
| | Class VI - Dynamite man and powder man. | LAUCT-Z2-6 | \$37.74 | \$50.08 | \$62.41 | X X X X X X X D Y |
| | Apprentice Rates: | | | | | |
| | 0-1,000 work hours | | \$32.20 | \$41.77 | \$51.33 | |
| | 1,001-2,000 work hours | | \$33.31 | \$43.43 | \$53.55 | |
| | 2,001-3,000 work hours | | \$34.42 | \$45.10 | \$55.77 | |
| | 3,001-4,000 work hours | | \$36.63 | \$48.41 | \$60.19 | |

Unofficial Rates For Informational Purposes Only

County: Genesee

zz alpha web rates

Date Rendered: 4/2/2018

Genesee County

Page 12 of 25

| Classification | | Straight Hourly | Time and a Half | Double Time | Overtime Provision | |
|--|--|--------------------|--------------------|----------------|--------------------|-------------------|
| Name | Description | | | | | |
| | Class VII - Restoration laborer, seeding, sodding, planting, cutting, mulching and topsoil grading and the restoration of property such as replacing mail boxes, wood chips, planter boxes and flagstones. | LAUCT-Z2-7 | \$30.01 | \$38.48 | \$46.95 | X X X X X X X D Y |
| | Apprentice Rates: | | | | | |
| | 0-1,000 work hours | \$26.41 | \$33.09 | \$39.75 | | |
| | 1,001-2,000 work hours | \$27.13 | \$34.17 | \$41.19 | | |
| | 2,001-3,000 work hours | \$27.85 | \$35.25 | \$42.63 | | |
| | 3,001-4,000 work hours | \$29.29 | \$37.41 | \$45.51 | | |
| Landscape Laborer | | | | | | |
| | Landscape Specialist: includes air, gas, and diesel equipment operator, skidsteer (or equivalent), lawn sprinkler installer on landscaping work where seeding, sodding, planting, cutting, trimming, backfilling, rough grading or maintenance of landscape projects occurs. | LLAN-Z1-A | \$28.98 | \$40.04 | \$51.09 | X X H X X X H D Y |
| | Comment Sundays paid at time & one half. Holidays paid at double time. | | | | | |
| | Skilled Landscape Laborer: small power tool operator, lawn sprinkler installers' tender, material mover, truck driver when seeding, sodding, planting, cutting, trimming, backfilling, rough grading or maintaining of landscape projects occurs | LLAN-Z1-B | \$24.76 | \$33.71 | \$42.65 | X X H X X X H D Y |
| | Comment Sundays paid at time & one half. Holidays paid at double time. | | | | | |
| Marble, Mosaic, Tile and Terrazzo Setter | | | | | | |
| | Marble, Mosaic, Tile and Terrazzo Setter | BR9-12-TL | \$43.37 | \$55.83 | \$68.29 | H H H H H H H D Y |
| | Comment 4 10s allowed M-F | | | | | |
| | Apprentice Rates: | | | | | |
| | 0-749 hours | \$33.89 | \$41.87 | \$49.85 | | |
| | 750-1499 hours | \$35.25 | \$43.91 | \$52.57 | | |
| | 1500-2249 hours | \$36.60 | \$45.93 | \$55.27 | | |
| | 2250-2999 hours | \$37.95 | \$47.96 | \$57.97 | | |
| | 3000-3749 hours | \$39.31 | \$50.00 | \$60.69 | | |
| | 3750-4499 hours | \$40.66 | \$52.03 | \$63.39 | | |
| Operating Engineer | | | | | | |
| | Compressor or Welding Machine | EN-AC | \$46.07 | \$57.38 | \$68.68 | X X H H D D D D Y |
| | Comment Make up day allowed Friday, Four 10 hour days may be scheduled Monday-Thursday or Tuesday-Friday. Work not performed due to weather, Monday-Thursday may be scheduled on Friday. | | | | | |

Unofficial Rates For Informational Purposes Only

County: Genesee

zz alpha web rates

Date Rendered: 4/2/2018

Genesee County

Page 13 of 25

| <u>Classification</u> | | Straight Hourly | Time and a Half | Double Time | Overtime Provision |
|---|--|--------------------|--------------------|----------------|--------------------|
| Name | Description | | | | |
| Forklift or Straight Mast | EN-F | \$47.52 | \$59.55 | \$71.58 | X X H H D D D D Y |
| Comment | Make up day allowed Four 10 hour days may be scheduled M-Th or T-F. Work not performed due to weather on M-Th may be scheduled on Friday | | | | |
| Fireman or Oiler | EN-FO | \$45.04 | \$55.83 | \$66.62 | X X H H D D D D Y |
| Comment | Make up day allowed Four 10 hour days may be scheduled Monday-Thursday or Tuesday-Friday. Work not performed due to weather, Monday-Thursday may be scheduled on Friday. | | | | |
| Lull or Extend-a-Boom Forklift | EN-L | \$53.38 | \$68.34 | \$83.30 | X X H H D D D D Y |
| Comment | Make up day allowed Four 10 hour days may be scheduled M-Th or T-F. Work not performed due to weather on M-Th may be scheduled on Friday | | | | |
| Crane with main boom & jib 120' or longer | EN-OS120 | \$56.92 | \$80.60 | \$104.28 | X X H H D D D D Y |
| Comment | Make up day allowed Four 10 hour days may be scheduled Monday-Thursday or Tuesday-Friday. Work not performed due to weather, Monday-Thursday may be scheduled on Friday | | | | |
| Crane w/ main Boom & Jib 220' or longer | EN-OSA | \$58.03 | \$75.32 | \$92.60 | X X H H D D D D Y |
| Comment | Make up day allowed Four 10 hour days may be scheduled Monday-Thursday or Tuesday-Friday. Work not performed due to weather, Monday-Thursday may be scheduled on Friday. | | | | |
| Crane w/ main Boom & Jib 300' or longer | EN-OSA3 | \$59.54 | \$74.73 | \$90.41 | X X H H D D D D Y |
| Comment | Make up day allowed Four 10 hour days may be scheduled Monday-Thursday or Tuesday-Friday. Work unable to be performed due to weather, Monday-Thursday may be scheduled on Friday. | | | | |
| Crane w/ main Boom & Jib 400' or longer | EN-OSA4 | \$61.04 | \$79.83 | \$98.62 | X X H H D D D D Y |
| Comment | Make up day allowed Four 10 hour days may be scheduled Monday-Thursday or Tuesday-Friday. Work not performed due to weather, Monday-Thursday may be scheduled on Friday. | | | | |
| Crane with main boom and jib 140' or longer | EN-OSB | \$57.74 | \$74.88 | \$92.02 | X X H H D D D D Y |
| Comment | Make up day allowed Four 10 hour days may be scheduled Monday-Thursday or Tuesday-Friday. Work unable to be performed due to weather, Monday-Thursday may be scheduled on Friday. | | | | |

Unofficial Rates For Informational Purposes Only

County: Genesee

zz alpha web rates

Date Rendered: 4/2/2018

Genesee County

Page 14 of 25

| <u>Classification</u> | | Straight Hourly | Time and a Half | Double Time | Overtime Provision |
|--|--|--------------------|--------------------|----------------|--------------------|
| Name | Description | | | | |
| Regular Crane Operator, Job Mechanic, Concrete Pump with Boom | EN-RC | \$56.06 | \$72.36 | \$88.66 | X X H H D D D D Y |
| Comment | Make up day allowed | | | | |
| | Four 10 hour days may be scheduled Monday-Thursday or Tuesday-Friday. Work not performed due to weather, Monday-Thursday may be scheduled on Friday. | | | | |
| | Apprentice Rates: | | | | |
| | 0-999 hours | \$44.78 | \$56.19 | \$67.60 | |
| | 1,000-1,999 hours | \$46.41 | \$58.64 | \$70.86 | |
| | 2,000-2,999 hours | \$48.04 | \$61.08 | \$74.12 | |
| | 3,000-3,999 hours | \$49.67 | \$63.53 | \$77.38 | |
| | 4,000-4,999 hours | \$51.31 | \$65.98 | \$80.66 | |
| | 5,000-5,999 hours | \$52.93 | \$68.42 | \$83.90 | |
| Regular Engineer, Hydro Excavator & Remote Controlled Concrete Breaker | EN-RE | \$55.11 | \$70.94 | \$86.76 | X X H H D D D D Y |
| Comment | Make up day allowed | | | | |
| | Four 10 hour days may be scheduled Monday-Thursday or Tuesday-Friday. Work not performed due to weather, Monday-Thursday may be scheduled on Friday. | | | | |
| Operating Engineer - Marine Construction | | | | | |
| Diver/Wet Tender/Tender/Rov Pilot/Rov Tender | GLF D | \$52.80 | \$79.20 | \$105.60 | H H H H H H D N |
| Diver/Wet Tender, Engineer (hydraulic dredge) | GLF-1 | \$72.32 | \$93.82 | \$115.32 | X X H H H H D Y |
| Comment | Make up day allowed | | | | |
| | Holiday pay = 2.5 times the straight hourly rate | | | | |
| <u>Subdivision of county</u> | all Great Lakes, islands therein, & connecting & tributary waters | | | | |
| Crane/Backhoe Operator, 70 ton or over Tug Operator, Mechanic/Welder, Assistant Engineer (hydraulic dredge), Leverman (hydraulic dredge), Diver Tender | GLF-2 | \$70.82 | \$91.57 | \$112.32 | X X H H H H D Y |
| Comment | Make up day allowed | | | | |
| | Holiday pay = 2.5 times the straight hourly rate | | | | |
| <u>Subdivision of county</u> | All Great Lakes, islands therein, & connecting & tributary waters | | | | |
| Friction, Lattice Boom or Crane License Certification | GLF-2B | \$72.32 | \$93.82 | \$115.32 | X X H H H H D Y |
| Comment | Make up day allowed | | | | |
| | Holiday pay = 2.5 times the straight hourly rate | | | | |
| <u>Subdivision of county</u> | All Great Lakes, islands, therein, & connecting & tributary waters | | | | |
| Deck Equipment Operator, Machineryman, Maintenance of Crane (over 50 ton capacity) or Backhoe (115,000 lbs or more), Tug/Launch Operator, Loader, Dozer on Barge, Deck Machinery | GLF-3 | \$66.27 | \$84.75 | \$103.22 | X X H H H H D Y |
| Comment | Make up day allowed | | | | |
| | Holiday pay = 2.5 times the straight hourly rate | | | | |
| <u>Subdivision of county</u> | All Great Lakes, islands therein, & connecting & tributary waters | | | | |

Unofficial Rates For Informational Purposes Only

County: Statewide

zz alpha web rates

Date Rendered: 4/2/2018

Statewide County

Page 15 of 25

| <u>Classification</u> | | Straight Hourly | Time and a Half | Double Time | Overtime Provision |
|--|---|--------------------|--------------------|----------------|--------------------|
| Name | Description | | | | |
| Deck Equipment Operator, (Machineryman/Fireman), (4 equipment units or more), Off Road Trucks, Deck Hand, Tug Engineer, & Crane Maintenance 50 ton capacity and under or Backhoe 115,000 lbs or less, Assistant Tug Operator | GLF-4 | \$60.07 | \$75.45 | \$90.82 | X X H H H H H D Y |
| Comment | Make up day allowed | | | | |
| | Holiday pay = 2.5 times the straight hourly rate | | | | |
| <u>Subdivision of county</u> | All Great Lakes, islands therein, & connecting & tributary waters | | | | |
| Operating Engineer Steel Work | | | | | |
| Forklift, 1 Drum Hoist | EN-324-EF | \$60.41 | \$79.00 | \$97.58 | H H D H H H D D Y |
| Comment | Make up day allowed | | | | |
| | 4 10s allowed M-Th with Friday makeup day because of bad weather | | | | |
| Crane w/ 120' boom or longer | EN-324-SW120 | \$63.11 | \$83.05 | \$102.98 | H H D H H H D D Y |
| Comment | Make up day allowed | | | | |
| | 4 10s allowed M-Th with Friday makeup day because of bad weather | | | | |
| Crane w/ 120' boom or longer w/ Oiler | EN-324-SW120-O | \$64.11 | \$84.55 | \$104.98 | H H D H H H D D Y |
| Comment | Make up day allowed | | | | |
| | 4 10s allowed M-Th with Friday makeup day because of bad weather | | | | |
| Crane w/ 140' boom or longer | EN-324-SW140 | \$64.29 | \$84.82 | \$105.34 | H H D H H H D D Y |
| Comment | Make up day allowed | | | | |
| | 4 10s allowed M-Th with Friday makeup day because of bad weather | | | | |
| Crane w/ 140' boom or longer W/ Oiler | EN-324-SW140-O | \$65.29 | \$86.32 | \$107.34 | H H D H H H D D Y |
| Comment | Make up day allowed | | | | |
| | 4 10s allowed M-Th with Friday makeup day because of bad weather | | | | |
| Boom & Jib 220' or longer | EN-324-SW220 | \$64.56 | \$85.22 | \$105.88 | H H D H H H D D Y |
| Comment | Make up day allowed | | | | |
| | 4 10s allowed M-Th with Friday makeup day because of bad weather | | | | |
| Crane w/ 220' boom or longer w/ Oiler | EN-324-SW220-O | \$65.56 | \$86.72 | \$107.88 | H H D H H H D D Y |
| Comment | Make up day allowed | | | | |
| | 4 10s allowed M-Th with Friday makeup day because of bad weather | | | | |
| Boom & Jib 300' or longer | EN-324-SW300 | \$66.06 | \$87.47 | \$108.88 | H H D H H H D D Y |
| Comment | Make up day allowed | | | | |
| | 4 10s allowed M-Th with Friday makeup day because of bad weather | | | | |
| Crane w/ 300' boom or longer w/ Oiler | EN-324-SW300-O | \$67.06 | \$88.97 | \$110.88 | H H D H H H D D Y |
| Comment | Make up day allowed | | | | |
| | 4 10s allowed M-Th with Friday makeup day because of bad weather | | | | |

Unofficial Rates For Informational Purposes Only

County: Genesee

zz alpha web rates

Date Rendered: 4/2/2018

Genesee County

Page 16 of 25

| Classification | | Straight Hourly | Time and a Half | Double Time | Overtime Provision |
|--|---|--------------------|--------------------|----------------|--------------------|
| Name | Description | | | | |
| Boom & Jib 400' or longer | EN-324-SW400 | \$67.56 | \$89.72 | \$111.88 | H H D H H H D D Y |
| Comment | Make up day allowed 4 10s allowed M-Th with Friday makeup day because of bad weather | | | | |
| Crane w/ 400' boom or longer w/ Oiler | EN-324-SW400-O | \$68.56 | \$91.22 | \$113.88 | H H D H H H D D Y |
| Comment | Make up day allowed 4 10s allowed M-Th with Friday makeup day because of bad weather | | | | |
| Crane Operator, Job Mechanic, 3 Drum Hoist & Excavator | EN-324-SWCO | \$62.75 | \$82.51 | \$102.26 | H H D H H H D D Y |
| Comment | Make up day allowed 4 10s allowed M-Th with Friday makeup day because of bad weather | | | | |
| | Apprentice Rates: | | | | |
| | 0-999 hours | \$49.40 | \$63.26 | \$77.11 | |
| | 1,000-1,999 hours | \$51.38 | \$66.23 | \$81.07 | |
| | 2,000-2,999 hours | \$53.35 | \$69.19 | \$85.01 | |
| | 3,000-3,999 hours | \$55.33 | \$72.16 | \$88.97 | |
| | 4,000-4,999 hours | \$57.30 | \$75.11 | \$92.91 | |
| | 5,000 hours | \$59.28 | \$78.08 | \$96.87 | |
| Crane Operator w/ Oiler | EN-324-SWCO-O | \$63.75 | \$84.01 | \$104.26 | H H D H H H D D Y |
| Comment | Make up day allowed 4 10s allowed M-Th with Friday makeup day because of bad weather | | | | |
| Compressor or Welder Operator | EN-324-SWCW | \$55.30 | \$71.33 | \$87.36 | H H D H H H D D Y |
| Comment | Make up day allowed 4 10s allowed M-Th with Friday makeup day because of bad weather | | | | |
| Hoisting Operator, 2 Drum Hoist, & Rubber Tire Backhoe | EN-324-SWHO | \$62.11 | \$81.55 | \$100.98 | H H D H H H D D Y |
| Comment | Make up day allowed 4 10s allowed M-Th with Friday makeup day because of bad weather | | | | |
| Oiler | EN-324-SWO | \$53.89 | \$69.22 | \$84.54 | H H D H H H D D Y |
| Comment | Make up day allowed 4 10s allowed M-Th with Friday makeup day because of bad weather | | | | |
| Tower Crane & Derrick where work is 50' or more | EN-324-SWTD50 | \$63.84 | \$84.14 | \$104.44 | H H D H H H D D Y |
| Comment | Make up day allowed 4 10s allowed M-Th with Friday makeup day because of bad weather | | | | |
| Tower Crane & Derrick 50' or more w/ Oiler | EN-324-SWTD50-O | \$64.84 | \$85.64 | \$106.44 | H H D H H H D D Y |
| Comment | Make up day allowed 4 10s allowed M-Th with Friday makeup day because of bad weather | | | | |

Unofficial Rates For Informational Purposes Only

County: Genesee

zz alpha web rates

Date Rendered: 4/2/2018

Genesee County

Page 17 of 25

| <u>Classification</u> | | Straight Hourly | Time and a Half | Double Time | Overtime Provision |
|--------------------------------|--|--------------------|--------------------|----------------|--------------------|
| Name | Description | | | | |
| Operating Engineer Underground | | | | | |
| Class I Equipment | EN-324A1-UC1 | \$55.54 | \$71.56 | \$87.57 | H H H H H H D Y |
| Apprentice Rates: | | | | | |
| | 0-999 hours | \$44.09 | \$55.30 | \$66.52 | |
| | 1,000-1,999 hours | \$45.68 | \$57.70 | \$69.70 | |
| | 2,000-2,999 hours | \$47.28 | \$60.09 | \$72.90 | |
| | 3,000-3,999 hours | \$48.88 | \$62.49 | \$76.10 | |
| | 4,000-4,999 hours | \$50.49 | \$64.91 | \$79.32 | |
| | 5,000-5,999 hours | \$52.09 | \$67.30 | \$82.52 | |
| Class II Equipment | EN-324A1-UC2 | \$50.81 | \$64.46 | \$78.11 | H H H H H H D Y |
| Class III Equipment | EN-324A1-UC3 | \$50.08 | \$63.37 | \$76.65 | H H H H H H D Y |
| Class IV Equipment | EN-324A1-UC4 | \$49.51 | \$62.52 | \$75.51 | H H H H H H D Y |
| Master Mechanic | EN-324A1-UMM | \$55.79 | \$71.93 | \$88.07 | H H H H H H D Y |
| Painter | | | | | |
| Painter | PT-1052-BR | \$35.80 | \$47.68 | \$59.55 | X X H X X X H D Y |
| Comment | Make up day allowed | | | | |
| | The regular weekly work schedule may consist of 4 10s on consecutive days, Monday thru Saturday. A make-up day may be scheduled for work missed due to holiday or inclement weather. | | | | |
| Apprentice Rates: | | | | | |
| | 1st year | \$23.93 | \$29.87 | \$35.81 | |
| | 2nd year, 1st 6 months | \$26.30 | \$33.43 | \$40.55 | |
| | 2nd year, 2nd 6 months | \$28.67 | \$36.98 | \$45.29 | |
| | 3rd year, 1st 6 months | \$31.05 | \$40.55 | \$50.05 | |
| | Until completion | \$33.43 | \$44.12 | \$54.81 | |

Unofficial Rates For Informational Purposes Only

County: Genesee

zz alpha web rates

Date Rendered: 4/2/2018

Genesee County

Page 18 of 25

| <u>Classification</u> | | Straight Hourly | Time and a Half | Double Time | Overtime Provision |
|--|---|--------------------|--------------------|----------------|--------------------|
| Name | Description | | | | |
| Painter - Work of a high risk nature of a falling height up to 30 feet | PT-1052-HR | \$36.10 | \$48.48 | \$60.85 | X X H X X X H D Y |
| Comment | Make up day allowed The regular weekly work schedule may consist of 4 10s on consecutive days, Monday thru Saturday. A make-up day may be scheduled for work missed due to holiday or inclement weather. | | | | |
| | Apprentice Rates: | | | | |
| | 1st year | \$23.73 | \$29.92 | \$36.11 | |
| | 2nd year, 1st 6 months | \$26.20 | \$33.63 | \$41.05 | |
| | 2nd year, 2nd 6 months | \$28.67 | \$37.33 | \$45.99 | |
| | 3rd year, 1st 6 months | \$31.15 | \$41.05 | \$50.95 | |
| | Until completion | \$33.63 | \$44.77 | \$55.91 | |
| Painter - All work of a falling height of 31 - 44 feet | PT-1052-HR01 | \$36.40 | \$48.93 | \$61.45 | X X H X X X H D Y |
| Comment | Make up day allowed The regular weekly work schedule may consist of 4 10s on consecutive days, Monday thru Saturday. A make-up day may be scheduled for work missed due to holiday or inclement weather. | | | | |
| | Apprentice Rates: | | | | |
| | 1st year | \$23.87 | \$30.13 | \$36.39 | |
| | 2nd year, 1st 6 months | \$26.38 | \$33.89 | \$41.41 | |
| | 2nd year, 2nd 6 months | \$28.89 | \$37.66 | \$46.43 | |
| | 3rd year, 1st 6 months | \$31.39 | \$41.41 | \$51.43 | |
| | Until completion | \$33.89 | \$45.16 | \$56.43 | |
| Painter - All work of a falling height of 45 - 59 feet | PT-1052-HR02 | \$36.50 | \$49.08 | \$61.65 | X X H X X X H D Y |
| Comment | Make up day allowed The regular weekly work schedule may consist of 4 10s on consecutive days, Monday thru Saturday. A make-up day may be scheduled for work missed due to holiday or inclement weather. | | | | |
| | Apprentice Rates: | | | | |
| | 1st year | \$23.93 | \$30.22 | \$36.51 | |
| | 2nd year, 1st 6 months | \$26.44 | \$33.99 | \$41.53 | |
| | 2nd year, 2nd 6 months | \$28.95 | \$37.75 | \$46.55 | |
| | 3rd year, 1st 6 months | \$31.47 | \$41.53 | \$51.59 | |
| | Until completion | \$33.99 | \$45.31 | \$56.63 | |
| Painter - All work of a falling height of 60 - 74 feet | PT-1052-HR03 | \$36.60 | \$49.23 | \$61.85 | X X H X X X H D Y |
| Comment | Make up day allowed The regular weekly work schedule may consist of 4 10s on consecutive days, Monday thru Saturday. A make-up day may be scheduled for work missed due to holiday or inclement weather. | | | | |
| | Apprentice Rates: | | | | |
| | 1st year | \$23.97 | \$30.28 | \$36.59 | |
| | 2nd year, 1st 6 months | \$26.50 | \$34.07 | \$41.65 | |
| | 2nd year, 2nd 6 months | \$29.02 | \$37.85 | \$46.69 | |
| | 3rd year, 1st 6 months | \$31.55 | \$41.65 | \$51.75 | |
| | Until completion | \$34.07 | \$45.43 | \$56.79 | |

Unofficial Rates For Informational Purposes Only

Genesee County

Page 19 of 25

| <u>Classification</u> | | Straight Hourly | Time and a Half | Double Time | Overtime Provision |
|--|---|--------------------|--------------------|----------------|--------------------|
| Name | Description | | | | |
| Painter - All work of a falling height of 75 - 89 feet | PT-1052-HR04 | \$36.70 | \$49.38 | \$62.05 | X X H X X X H D Y |
| Comment | Make up day allowed The regular weekly work schedule may consist of 4 10s on consecutive days, Monday thru Saturday. A make-up day may be scheduled for work missed due to holiday or inclement weather. | | | | |
| | Apprentice Rates: | | | | |
| | 1st year | \$24.03 | \$30.37 | \$36.71 | |
| | 2nd year, 1st 6 months | \$26.56 | \$34.17 | \$41.77 | |
| | 2nd year, 2nd 6 months | \$29.09 | \$37.96 | \$46.83 | |
| | 3rd year, 1st 6 months | \$31.63 | \$41.77 | \$51.91 | |
| | Until completion | \$34.17 | \$45.58 | \$56.99 | |
| Painter - All work of a falling height of 90 - 104 feet | PT-1052-HR05 | \$36.80 | \$49.53 | \$62.25 | X X H X X X H D Y |
| Comment | Make up day allowed The regular weekly work schedule may consist of 4 10s on consecutive days, Monday thru Saturday. A make-up day may be scheduled for work missed due to holiday or inclement weather. | | | | |
| | Apprentice Rates: | | | | |
| | 1st year | \$24.07 | \$30.43 | \$36.79 | |
| | 2nd year, 1st 6 months | \$26.62 | \$34.25 | \$41.89 | |
| | 2nd year, 2nd 6 months | \$29.16 | \$38.07 | \$46.97 | |
| | 3rd year, 1st 6 months | \$31.71 | \$41.89 | \$52.07 | |
| | Until completion | \$34.25 | \$45.70 | \$57.15 | |
| Painter - All work of a falling height of 105 - 119 feet | PT-1052-HR06 | \$36.90 | \$49.68 | \$62.45 | X X H X X X H D Y |
| Comment | Make up day allowed The regular weekly work schedule may consist of 4 10s on consecutive days, Monday thru Saturday. A make-up day may be scheduled for work missed due to holiday or inclement weather. | | | | |
| | Apprentice Rates: | | | | |
| | 1st year | \$24.13 | \$30.52 | \$36.91 | |
| | 2nd year, 1st 6 months | \$26.68 | \$34.35 | \$42.01 | |
| | 2nd year, 2nd 6 months | \$29.23 | \$38.17 | \$47.11 | |
| | 3rd year, 1st 6 months | \$31.79 | \$42.01 | \$52.23 | |
| | Until completion | \$34.35 | \$45.85 | \$57.35 | |
| Painter - All work of a falling height of 120 - 134 feet | PT-1052-HR07 | \$37.00 | \$49.83 | \$62.65 | X X H X X X H D Y |
| Comment | Make up day allowed The regular weekly work schedule may consist of 4 10s on consecutive days, Monday thru Saturday. A make-up day may be scheduled for work missed due to holiday or inclement weather. | | | | |
| | Apprentice Rates: | | | | |
| | 1st year | \$24.17 | \$30.58 | \$36.99 | |
| | 2nd year, 1st 6 months | \$26.74 | \$34.43 | \$42.13 | |
| | 2nd year, 2nd 6 months | \$29.30 | \$38.27 | \$47.25 | |
| | 3rd year, 1st 6 months | \$31.87 | \$42.13 | \$52.39 | |
| | Until completion | \$34.43 | \$45.97 | \$57.51 | |

Unofficial Rates For Informational Purposes Only

Genesee County

Page 20 of 25

| <u>Classification</u> | | Straight Hourly | Time and a Half | Double Time | Overtime Provision |
|--|---|--------------------|--------------------|----------------|--------------------|
| Name | Description | | | | |
| Painter - All work of a falling height of 135 - 149 feet | PT-1052-HR08 | \$37.10 | \$49.98 | \$62.85 | X X H X X X H D Y |
| Comment | Make up day allowed The regular weekly work schedule may consist of 4 10s on consecutive days, Monday thru Saturday. A make-up day may be scheduled for work missed due to holiday or inclement weather. | | | | |
| | Apprentice Rates: | | | | |
| | 1st year | \$24.23 | \$30.67 | \$37.11 | |
| | 2nd year, 1st 6 months | \$26.80 | \$34.53 | \$42.25 | |
| | 2nd year, 2nd 6 months | \$29.37 | \$38.38 | \$47.39 | |
| | 3rd year, 1st 6 months | \$31.95 | \$42.25 | \$52.55 | |
| | Until completion | \$34.53 | \$46.12 | \$57.71 | |
| Painter - All work of a falling height of 150 - 164 feet | PT-1052-HR09 | \$37.20 | \$50.13 | \$63.05 | X X H X X X H D Y |
| Comment | Make up day allowed The regular weekly work schedule may consist of 4 10s on consecutive days, Monday thru Saturday. A make-up day may be scheduled for work missed due to holiday or inclement weather. | | | | |
| | Apprentice Rates: | | | | |
| | 1st year | \$24.27 | \$30.73 | \$37.19 | |
| | 2nd year, 1st 6 months | \$26.86 | \$34.61 | \$42.37 | |
| | 2nd year, 2nd 6 months | \$29.45 | \$38.50 | \$47.55 | |
| | 3rd year, 1st 6 months | \$32.03 | \$42.37 | \$52.71 | |
| | Until completion | \$34.61 | \$46.24 | \$57.87 | |
| Painter - All work of a falling height of 165 - 179 feet | PT-1052-HR10 | \$37.30 | \$50.28 | \$63.25 | X X H X X X H D Y |
| Comment | Make up day allowed The regular weekly work schedule may consist of 4 10s on consecutive days, Monday thru Saturday. A make-up day may be scheduled for work missed due to holiday or inclement weather. | | | | |
| | Apprentice Rates: | | | | |
| | 1st year | \$24.33 | \$30.82 | \$37.31 | |
| | 2nd year, 1st 6 months | \$26.92 | \$34.71 | \$42.49 | |
| | 2nd year, 2nd 6 months | \$29.51 | \$38.59 | \$47.67 | |
| | 3rd year, 1st 6 months | \$32.11 | \$42.49 | \$52.87 | |
| | Until completion | \$34.71 | \$46.39 | \$58.07 | |
| Painter - All work of a falling height of 180 - 194 feet | PT-1052-HR11 | \$37.40 | \$50.43 | \$63.45 | X X H X X X H D Y |
| Comment | Make up day allowed The regular weekly work schedule may consist of 4 10s on consecutive days, Monday thru Saturday. A make-up day may be scheduled for work missed due to holiday or inclement weather. | | | | |
| | Apprentice Rates: | | | | |
| | 1st year | \$24.37 | \$30.88 | \$37.39 | |
| | 2nd year, 1st 6 months | \$26.98 | \$34.79 | \$42.61 | |
| | 2nd year, 2nd 6 months | \$29.59 | \$38.71 | \$47.83 | |
| | 3rd year, 1st 6 months | \$32.19 | \$42.61 | \$53.03 | |
| | Until completion | \$34.79 | \$46.51 | \$58.23 | |

Unofficial Rates For Informational Purposes Only

Genesee County

Page 21 of 25

| Classification | | Straight Hourly | Time and a Half | Double Time | Overtime Provision |
|--|---|--------------------|--------------------|----------------|--------------------|
| Name | Description | | | | |
| Painter - All work of a falling height of 195 - 209 feet | PT-1052-HR12 | \$37.50 | \$50.58 | \$63.65 | X X H X X X H D Y |
| Comment | Make up day allowed The regular weekly work schedule may consist of 4 10s on consecutive days, Monday thru Saturday. A make-up day may be scheduled for work missed due to holiday or inclement weather. | | | | |
| | Apprentice Rates: | | | | |
| | 1st year | \$24.43 | \$30.97 | \$37.51 | |
| | 2nd year, 1st 6 months | \$27.04 | \$34.89 | \$42.73 | |
| | 2nd year, 2nd 6 months | \$29.65 | \$38.80 | \$47.95 | |
| | 3rd year, 1st 6 months | \$32.27 | \$42.73 | \$53.19 | |
| | Until completion | \$34.89 | \$46.66 | \$58.43 | |
| Painter - All work of a falling height of 210 - 224 feet | PT-1052-HR13 | \$37.60 | \$50.73 | \$63.85 | X X H X X X H D Y |
| Comment | Make up day allowed The regular weekly work schedule may consist of 4 10s on consecutive days, Monday thru Saturday. A make-up day may be scheduled for work missed due to holiday or inclement weather. | | | | |
| | Apprentice Rates: | | | | |
| | 1st year | \$24.47 | \$31.03 | \$37.59 | |
| | 2nd year, 1st 6 months | \$27.10 | \$34.97 | \$42.85 | |
| | 2nd year, 2nd 6 months | \$29.73 | \$38.92 | \$48.11 | |
| | 3rd year, 1st 6 months | \$32.35 | \$42.85 | \$53.35 | |
| | Until completion | \$34.97 | \$46.78 | \$58.59 | |
| Painter - Sign Display | | | | | |
| The trade jurisdiction consists of painting and other related surface finishing operations; lettering, and all operations so related; pictorial and graphic art work; screen process procedures; application of photographs, translates, refinished surface-type materials used in lieu of painted methods, display graphics; adhesive backed lettering and art work; sign hanging, sign installation, erection and construction; bulletin board construction; plastic sign fabrication; advertising displays and exhibits; and the preparing of surfaces for finishing of the same to include but not limited to application of filler of seams, grooves, nail and/or screw holes; and such area practices pertaining to the sign and display industry. | PT-591 | \$19.94 | \$29.93 | \$39.88 | X X X X X X X D N |
| Pipe and Manhole Rehab | | | | | |
| General Laborer for rehab work or normal cleaning and cctv work-top man, scaffold man, CCTV assistant, jetter-vac assistant | TM247 | \$28.20 | \$38.20 | | H H H H H H H H N |
| Tap cutter/CCTV Tech/Grout Equipment Operator: unit driver and operator of CCTV; grouting equipment and tap cutting equipment | TM247-2 | \$32.70 | \$44.95 | | H H H H H H H H N |

Unofficial Rates For Informational Purposes Only

County: Statewide

zz alpha web rates

Date Rendered: 4/2/2018

Statewide County

Page 22 of 25

| Classification | | Straight Hourly | Time and a Half | Double Time | Overtime Provision |
|---|--------------------------|--------------------|--------------------|----------------|--------------------|
| Name | Description | | | | |
| CCTV Technician/Combo Unit Operator: unit driver and operator of cctv unit or combo unit in connection with normal cleaning and televising work | TM247-3 | \$31.45 | \$43.07 | | H H H H H H H N |
| Boiler Operator: unit driver and operator of steam/water heater units and all ancillary equipment associated | TM247-4 | \$33.20 | \$45.70 | | H H H H H H H N |
| Combo Unit driver & Jetter-Vac Operator | TM247-5 | \$33.20 | \$45.70 | | H H H H H H H N |
| Pipe Bursting & Slip-lining Equipment Operator | TM247-6 | \$34.20 | \$47.20 | | H H H H H H H N |
| Plasterer | | | | | |
| Plasterer | BR9-12-PL | \$44.02 | \$56.73 | \$69.43 | H H H H H H D Y |
| Comment | | | | | |
| 4 10s allowed M-F | | | | | |
| | Apprentice Rates: | | | | |
| | 0-749 hours | \$34.36 | \$42.49 | \$50.64 | |
| | 750-1499 hours | \$35.74 | \$44.57 | \$53.40 | |
| | 1500-2249 hours | \$37.12 | \$46.63 | \$56.16 | |
| | 2250-2999 hours | \$38.50 | \$48.71 | \$58.92 | |
| | 3000-3749 hours | \$39.88 | \$50.77 | \$61.68 | |
| | 3750-4499 hours | \$41.26 | \$52.85 | \$64.44 | |
| Plasterer | PL16-3 | \$36.61 | \$48.48 | \$60.34 | H H H H H H D N |
| | Apprentice Rates: | | | | |
| | 1st year | \$28.30 | \$36.01 | \$43.72 | |
| | 2nd year | \$30.68 | \$39.58 | \$48.48 | |
| | 3rd year | \$33.05 | \$43.14 | \$53.22 | |
| Plumber, Pipefitter, HVAC & Refrigeration | | | | | |
| Pipe Trades Helper (Mechanical Helper) | PL-370-PFH | \$22.69 | \$34.04 | \$45.38 | H H H H H H D Y |
| Comment | | | | | |
| 4 10s allowed M-F | | | | | |
| Plumber trainee helper | PL-370-PLH | \$22.69 | \$34.04 | \$45.38 | H H H H H H D Y |
| Comment | | | | | |
| 4 10s allowed M-F | | | | | |

Unofficial Rates For Informational Purposes Only

County: Genesee

zz alpha web rates

Date Rendered: 4/2/2018

Genesee County

Page 23 of 25

| <u>Classification</u> | | Straight Hourly | Time and a Half | Double Time | Overtime Provision |
|---|----------------|--------------------|--------------------|----------------|--------------------|
| Name | Description | | | | |
| Plumber, Pipefitter, Welder, HVAC & Refrigeration | | | | | |
| Plumber, Pipefitter, Welder, HVAC & Refrigeration | PL-370 | \$55.01 | \$82.07 | \$109.12 | H H H H H H D Y |
| Comment 4 10s allowed M-F | | | | | |
| Apprentice Rates: | | | | | |
| | 1st 6 months | \$26.19 | \$39.01 | \$51.83 | |
| | 2nd 6 months | \$27.99 | \$41.71 | \$55.43 | |
| | 3rd 6 months | \$34.80 | \$51.93 | \$69.05 | |
| | 4th 6 months | \$36.61 | \$54.64 | \$72.67 | |
| | 5th 6 months | \$38.41 | \$57.34 | \$76.27 | |
| | 6th 6 months | \$40.22 | \$60.05 | \$79.89 | |
| | 7th 6 months | \$42.02 | \$62.75 | \$83.49 | |
| | 8th 6 months | \$43.83 | \$65.47 | \$87.11 | |
| | 9th 6 months | \$45.63 | \$68.17 | \$90.71 | |
| | final 6 months | \$47.44 | \$70.89 | \$94.33 | |
| Roofer | | | | | |
| Commercial Roofer | RO-149-MMA | \$38.61 | \$50.72 | \$62.82 | H H H H H H D Y |
| Comment Make up day allowed Straight time is not to exceed ten (10) hours per day or forty (40) hours per week. | | | | | |
| Apprentice Rates: | | | | | |
| | Apprentice 1 | \$23.23 | \$27.64 | \$32.06 | |
| | Apprentice 2 | \$25.14 | \$30.51 | \$35.88 | |
| | Apprentice 3 | \$27.09 | \$33.44 | \$39.78 | |
| | Apprentice 4 | \$29.00 | \$36.30 | \$43.60 | |
| | Apprentice 5 | \$30.92 | \$39.18 | \$47.44 | |
| | Apprentice 6 | \$32.83 | \$42.04 | \$51.26 | |
| Sewer Relining | | | | | |
| Class I-Operator of audio visual CCTV system including remote in-ground cutter and other equipment used in conjunction with CCTV system. | SR-I | \$43.66 | \$59.01 | \$74.36 | H H H H H H D N |
| Class II-Operator of hot water heaters and circulation system; water jetters; and vacuum and mechanical debris removal systems and those assisting. | | | | | |
| Class II-Operator of hot water heaters and circulation system; water jetters; and vacuum and mechanical debris removal systems and those assisting. | SR-II | \$42.13 | \$56.72 | \$71.30 | H H H H H H D N |

Unofficial Rates For Informational Purposes Only

County: Statewide

zz alpha web rates

Date Rendered: 4/2/2018

Genesee County

Page 24 of 25

| <u>Classification</u> | | Straight Hourly | Time and a Half | Double Time | Overtime Provision |
|------------------------------------|--|--------------------|--------------------|----------------|--------------------|
| Name | Description | | | | |
| Sheet Metal Worker | | | | | |
| Sheet Metal Worker | SHM-7-4 | \$52.05 | \$66.87 | \$81.69 | H H H X H H D Y |
| Comment | Make up day allowed | | | | |
| | Saturday, 4 10s allowed as consecutive days, M-Th or T-F | | | | |
| | Apprentice Rates: | | | | |
| | 1st 6 months | \$26.93 | \$33.60 | \$40.27 | |
| | 2nd 6 months | \$28.41 | \$35.82 | \$43.23 | |
| | 3rd 6 months | \$29.89 | \$38.04 | \$46.19 | |
| | 4th 6 months | \$31.37 | \$40.26 | \$49.15 | |
| | 5th 6 months | \$41.23 | \$50.87 | \$60.50 | |
| | 6th 6 months | \$42.71 | \$53.09 | \$63.46 | |
| | 7th 6 months | \$44.19 | \$55.31 | \$66.42 | |
| | 8th 6 months | \$45.67 | \$57.53 | \$69.38 | |
| Sprinkler Fitter | | | | | |
| Sprinkler Fitter | SP 669 | \$51.64 | \$68.45 | \$85.26 | H H H H H H D Y |
| | Make up day allowed | | | | |
| | Apprentice Rates: | | | | |
| | Class 1 | \$23.03 | \$30.60 | \$38.16 | |
| | Class 2 | \$24.71 | \$33.12 | \$41.52 | |
| | Class 3 | \$34.01 | \$43.26 | \$52.50 | |
| | Class 4 | \$35.69 | \$45.78 | \$55.86 | |
| | Class 5 | \$37.62 | \$48.55 | \$59.47 | |
| | Class 6 | \$39.30 | \$51.07 | \$62.83 | |
| | Class 7 | \$40.99 | \$53.60 | \$66.21 | |
| | Class 8 | \$42.67 | \$56.12 | \$69.57 | |
| | Class 9 | \$44.35 | \$58.64 | \$72.93 | |
| | Class 10 | \$46.03 | \$61.16 | \$76.29 | |
| Tile, Marble and Terrazzo Finisher | | | | | |
| Finisher | BR9-12-TF | \$36.72 | \$47.07 | \$57.42 | H H H H H H D Y |
| Comment | 4 10s allowed M-F | | | | |
| | Apprentice Rates: | | | | |
| | 0-749 hours | \$28.83 | \$35.45 | \$42.08 | |
| | 750-1499 hours | \$29.96 | \$37.15 | \$44.34 | |
| | 1500-2249 hours | \$31.09 | \$38.84 | \$46.60 | |
| | 2250-2999 hours | \$32.21 | \$40.52 | \$48.84 | |
| | 3000-3749 hours | \$33.34 | \$42.21 | \$51.10 | |
| | 3750-4499 hours | \$34.47 | \$43.91 | \$53.36 | |

Unofficial Rates For Informational Purposes Only

County: Genesee

zz alpha web rates

Date Rendered: 4/2/2018

Genesee County

Page 25 of 25

| <u>Classification</u> | | Straight Hourly | Time and a Half | Double Time | Overtime Provision |
|-----------------------|---|--------------------|--------------------|----------------|--------------------|
| Name | Description | | | | |
| Truck Driver | | | | | |
| | on all trucks of 8 cubic yard capacity or less (except dump trucks of 8 cubic yard capacity or over, tandem axle trucks, transit mix and semis, euclid type equipment, double bottoms and low boys) | TM-RB1 | \$44.10 | \$48.81 | H H H H H H H Y |
| | of all trucks of 8 cubic yard capacity or over | TM-RB1A | \$44.20 | \$48.96 | H H H H H H H Y |
| | on euclid type equipment | TM-RB1B | \$44.35 | \$49.19 | H H H H H H H Y |
| | Make up day allowed | | | | |

Unofficial Rates For Informational Purposes Only

County: Genesee

zz alpha web rates

Date Rendered: 4/2/2018

ATTACHMENT 3

**APPENDIX 8- EVALUATION CRITERIA & SCORING-
REVISED 4/17/18**

Contractor: _____

Bid #: _____

EVALUATION CRITERIA AND SCORING – Commercial Bid Packets – Demo & Abate

The GCLBA will evaluate the four lowest cost proposals received and identify the submittals that are the most responsive, responsible and offer the best service to the GCLBA. Additional proposals will only be evaluated in the event that award cannot be made to one of the four lowest cost proposals. The GCLBA will consider Bidder qualifications, financial viability, project references, experience with comparable projects, and projects with concurrent timelines. Specifically, each RFP package will be reviewed based on the following selection criteria:

A. PROPOSAL/EVALUATION CRITERIA:

| Evaluation Factors | Maximum Points |
|--|-----------------------|
| Ability to Meet Production Goals within Timelines The bidder's demonstration of understanding of scope of work, readiness to proceed and capacity to complete work assigned within timeframes required. | 30* |
| Experience working on environmental cleanup or UST removal projects for the EPA, MDEQ, government or private entity. | 5 |
| HUD Section 3 Contractors can receive additional consideration in scoring per Section 3 Regulations in 24 CFR Part 135 for: 1. Being a Section 3 Certified Business Concern, and 2. Submitting a Section 3 Strategy to comply with the Section 3 training and employment preference or contracting preference. | 15 |
| Price The ability to demonstrate reasonable costs in performing scope of work identified in the RFP. | 50 |

* Up to twenty (20) points may be deducted when evaluating Contractor capacity. GCLBA staff will consider past experience with Contractor's response to issues and complaints, including the timeframe in which the Contractor responded to identified issues and where Contractor performed substandard work (work performed by Contractor or Contractor's subcontractors that did not meet bid specifications) on any previous GCLBA projects.

Contractor: _____

Bid #: _____

Ability to Meet Production Goals within Timelines (30 Points)

1. **Experience** in the appropriate scope of work as outlined in the RFP. (3 points)

| | |
|--|----------|
| Five (5) to nine (9) years of experience in the demolition and disposal of residential/commercial structures. | 1 Point |
| Ten (10) or more years of experience in the demolition and disposal of residential/commercial structures. | 3 Points |

2. **Capacity – Part 1:** Does the firm demonstrate through their RFP packet that the firm has the capacity and experience to complete the projects **within the time frame identified in this Request for Proposal?** *(If they do not have the required equipment, are they subcontracting with a company/individual that has the required qualifications?).* (10 points)

| | |
|---|----------------|
| Contractor demonstrates experience on similar projects within the past five years. | Up to 2 Points |
| Staffing: 0-25 employees (1 point) 26-50 employees (2points) 51- 100 employees (3 points) 100-150 employees (4 points) 150+ employees (5 points) | Up to 5 Points |
| Experience and licensure of committed employees | Up to 3 points |

- ☐ Does the firm have **adequate staffing** to complete the project **within the time frame identified in this Request for Proposal?** *(If not, are they subcontracting with a company/individual that has the required qualifications?) An answer of “No” to this question will result in zero (0) points above or a determination that the bid is “non-responsive” depending upon the discrepancy.*
- ☐ Does the firm have **adequate equipment** to complete project **within the time frame identified in this Request for Proposal?** *(If not, are they subcontracting with a company/individual that has the required qualifications?) An answer of “No” to this question will result in zero (0) points above or a determination that the bid is “non-responsive” depending upon the discrepancy.*
- ☐ Does the firm have **adequate licensing** to complete project? *(If not, are they subcontracting with a company/individual that has the required qualifications?) An answer of “No” to this question will result in a determination that the bid is “non-responsive.” See THRESHOLD REQUIREMENTS.*

Contractor: _____

Bid #: _____

3. **Capacity – Part 2: Up to twenty (20) points may be deducted when evaluating Contractor capacity.** GCLBA staff will consider past experience with Contractor's response to issues and complaints, including the timeframe in which the Contractor responded to identified issues and where Contractor performed substandard work (work performed by Contractor or Contractor's subcontractors that did not meet bid specifications) on any GCLBA projects within the past 1 year from final payment on a contract.

| | |
|--|-------------------|
| Contractor has no documented outstanding or unresolved issues as outlined below: | Deduct 0 Points |
| Contractor has outstanding/unresolved issues and/or complaints on any GCLBA projects. (Deduct exists until issue is resolved) | Deduct 5 Points* |
| Contractor took more than ten business days to respond and/or demonstrated a lack of response to and GCLBA and/or neighbor complaints and/or issues. (Deduct expires 1 year from the date GCLBA approves issue resolution) | Deduct 5 Points* |
| Contractor performed substandard work (work performed by Contractor or Contractor's subcontractors that did not meet bid specifications) on previous GCLBA projects. (Deduct expires 1 year from the date GCLBA approves issue resolution) | Deduct 10 Points* |

*Attach the record of above described instances.

4. **Demonstrated understanding of the scope of work (17 points) – Threshold Requirements**

| | | |
|---|---|----------------|
| References: Has contractor held contracts with GCLBA in the past 5 years? No= See A below; Yes = See C below A. If contractor has not held a contact with GCLBA in the past 5 years, are references and projects provided for a similar time frame similar/appropriate? (No = 0 points; Yes = See B below) B. Does a sample of project contacts provide a reference noting the contract was completed on time, on budget and without complaints? (No = 0 points; Yes = 3 points)? (No = 0 points; Yes = 3 points) C. If contractor has held contracts with GCLBA in past 5 years, was the work completed on time, on budget, and without complaints? (No = 0 points; Yes = 5 points) | | Up to 5 Points |
| RFP submitted included all of the required submittals/documentation & signature | | Up to 3 Points |
| Required (Y/N) | Additional State Licenses and/MBWE/or certification included (No additional points awarded if required for the project) | Up to 5 points |
| Y | - Asbestos Abatement Licenses (1 Point) | |
| Y | - HAZWOPER Certification (1 Point) | |
| | - Contractor us MBE/WBE/DVE (2 points) or - submits plan to utilize MBE/WBE/DVE as sub (1 point) | |
| | - Lead Awareness/Abatement (1 Point) | |
| | - City of Flint Sidewalk Licensed Contractor (1 Point) | |
| | - Storm Water Management Certifications (1 Point) | |

Bid #: _____

K:\Irc\Demo\bids\Template\Evaluation Criteria

Contractor: _____

Bid #: _____

Does the firm have **adequate staffing** to complete the required number of projects stated in their proposal **on a weekly basis** (If not, are they subcontracting with a company/individual that has the required qualifications?)

N/A YES NO

Does the firm have **adequate equipment and licensing** to complete the required number of projects stated in their proposal **on a weekly basis** (If not, are they subcontracting with a company/individual that has the required qualifications?)

N/A YES NO

If the answer to the above questions is “No” then submission is to be considered NON-RESPONSIVE.

Section 3 Preference (15 Points)

1. Certified Section 3 Business Concerns. (10 points)

Contractors certified as Section 3 Business Concerns will receive priority consideration by category as defined in 24 CFR 135.36.

| | |
|--|------------------|
| Category 1 Section 3 Business Concern | 10 Points |
| Category 2 Section 3 Business Concern | 7 Points |
| Category 3 Section 3 Business Concern | 4 Points |
| Not a Section 3 Business Concern | 0 Points |

2. Section 3 Strategy- All Contractors(5 points)

- Did the contractor submit an appropriate Section 3 Strategy to comply with the Section 3 training and employment preference or contracting preference? (No = 0 points, Yes = see next question)
- Has the contractor previously submitted a Section 3 Strategy and received preference in scoring as a result? (No = 5 points, Yes = see next question)
- If the contractor has previously submitted and received preference for a Section 3 Strategy, did the contractor successfully implement the strategy and supply the required reports? (No = 0 points, Yes = 5 points)
- Contractor did not submit a Section 3 Strategy. (0 points)

Contractor: _____

Bid #: _____

Evaluating Pricing Proposal

Pricing will be evaluated and scored as follows:

The maximum points allowable (50) will be divided by the number of eligible responding bidders. The lowest responsive bidder will receive the maximum points (50). The next lowest responsive bidder will receive the maximum points (50) less the quotient of 50 divided by the number of eligible responding bidders. Each eligible bidder will be awarded pricing points based on the points awarded to the bidder with the closest bid price without exceeding the bid in question, less the quotient. For example, if there are four (4) eligible responsive bids, pricing points will be awarded as follows:

| Bidder | Bid Price | Bid Ranking | Pricing Score |
|---------------|------------------|--------------------|----------------------|
| Bidder A | \$10,000. | 3 | 25 |
| Bidder B | \$9,500.00 | 1 | 50 |
| Bidder C | \$12,500.00 | 4 | 12.5 |
| Bidder D | \$9,850.00 | 2 | 37.5 |

To achieve the Pricing Score, divide the maximum points possible by the number of eligible bidders: $50/4=12.5$. Then subtract the quotient from the score of the previous bidder subsequently.

- Bidder B, as lowest responsive bid will receive fifty (50) points for pricing.
- Bidder D, as next lowest responsive bid will receive 37.5 points for pricing ($50-12.5=37.5$)
- Bidder A, as next lowest responsive bid after D, will receive 25 points for pricing ($37.5-12.5=25$)
- Bidder C, as the as next lowest responsive bid after A, will receive 12.5 points for pricing ($25-12.5=12.5$)

A quotient will be rounded to the nearest tenth of a decimal for subtraction purposes. Should two or more eligible bidders have the same pricing, they shall receive the same scoring depending on where they fall in the formula (i.e. should Bidder D and Bidder A in the example above both bid \$9,850.00, they both would have been awarded 37.5 points [$50-12.5=37.5$]. Bidder C would then have received 25 points.)

In the event that the highest scoring Bidders' total scores are within a 5 point spread of one another, GCLBA reserves the right to award the contract to the Bidder with the most advantageous pricing proposal at its discretion.

SELECTION PROCESS

The Selection Committee comprised of GCLBA staff will review qualifications in accordance with the evaluation criteria set forth herein. Proposals that are submitted on time and comply with the mandatory requirements of the RFP will be evaluated in accordance with the terms of the RFP. Any contract resulting from this RFP will not necessarily be awarded to the vendor with the lowest price. Instead, contract(s) shall be awarded to vendor(s) whose proposal(s) is the most responsive, responsible and offers the best service to the GCLBA in accordance with criteria set forth in RFP.

ATTACHMENT 4

| Asbestos Unit Rate Schedule | | | |
|------------------------------------|--|-------------|-------------------|
| Item No. | Description | Unit | Unit Price |
| 1 | Sprayed-on Fireproofing | Square Foot | |
| 2 | Hard Wall/Ceiling Plaster (all layers, metal or wood lathe) | Square Foot | |
| 3 | Soft/Decorative Plaster (all layers, including substrate if necessary) | Square Foot | |
| 4 | Popcorn or Sprayed-on Ceiling or Wall Texture (all layers, including substrate if necessary) | Square Foot | |
| 5 | Drywall/Mud Compound | Square Foot | |
| 6 | Thermal System Insulation (TSI) Straight Pipe < 6-inch diameter | Linear Foot | |
| 7 | TSI Straight Pipe > 6 to 12 inch diameter | Linear Foot | |
| 8 | TSI Straight Pipe > 12 inch diameter | Linear Foot | |
| 9 | TSI Mud Fitting < 6 inch diameter | Each | |
| 10 | TSI Mud Fitting > 6 to 12 inch diameter | Each | |
| 11 | TSI Mud Fitting > 12 inch diameter | Each | |
| 12 | Duct Insulation (cloth or paper) | Square Foot | |
| 13 | Duct Insulation (fiberglass with ACM seam mud) | Square Foot | |
| 14 | Undercoated Sink | Each | |
| 15 | Fire Door | Each | |
| 16 | Floor Tile Only (any size) | Square Foot | |
| 17 | Floor Tile and Mastic (any size, any mastic type) | Square Foot | |
| 18 | Linoleum/Resilient Sheetting | Square Foot | |
| 19 | Linoleum/Resilient Sheetting and Mastic (any type) | Square Foot | |
| 20 | Window with associated caulk and/or glazing (any size including frame) | Each | |
| 21 | Furnace, boiler, or tank insulation (mud and jacket) | Square Foot | |
| 22 | Transite (Panels, Siding or Board) | Square Foot | |
| 23 | Fireproof Panels Square | Square Foot | |
| 24 | Asphalt Brick Siding (e.g., Insul-Brick, Brick-Kote, etc.) | Square Foot | |
| 25 | Electrical Panel | Each | |
| 26 | Glued-on ceiling tiles (any size) and glue pods | Each | |
| 27 | Construction Adhesives/other glue pods | Each | |
| 28 | Cove Base | Square Foot | |
| 29 | Vermiculite Insulation | Cubic Yard | |
| 30 | Miscellaneous Asbestos Debris (any type, total quabtity) | Cubic Foot | |
| 31 | Cementious Materials | Square Foot | |
| 32 | Roofing/Flashing/Tar (any type) | Square Foot | |
| 33 | Light Fixture Heat Shields | Each | |
| 34 | Foundation, wall or block caulk | Linear Foot | |
| 35 | Transite / asbestos utility piping (any size) | Linear Foot | |

| Hazardous Material Unit Rate Schedule | | | |
|--|---|-------------|-------------------|
| Item No. | Description | Unit | Unit Price |
| 36 | PCB or other ballasts | Each | |
| 37 | Fluorescent light tubes, > 4feet | Each | |
| 38 | Fluorescent light tubes, 4' or less | Each | |
| 39 | Mercury thermostats or switches | Each | |
| 40 | Misc household chemical containers | Each | |
| 41 | CFC (refrigerator, freezer, any size) | Each | |
| 42 | CFC A/C unit (window or whole house) | Each | |
| 43 | Oil filled equipment | Each | |
| 44 | Gas cylinders (any size and type including, but not limited to: propane, oxygen, acetylene, etc.) | Each | |
| 45 | High pressure light fixtures (sodium, mercury vapor, etc.) | Each | |
| 46 | Heating oil or other bulk oil | Gallon | |
| 47 | Miscellaneous Aerosol Containers | Each | |
| 48 | Car/vehicle battery | Each | |
| 49 | Bicycle tires Each | Each | |
| 50 | Automobile or truck tires | Each | |
| 51 | Television, microwave, computer monitor | Each | |
| 52 | Smoke detector | Each | |
| 53 | Paint cans (latex, oil, etc. any size) | Each | |
| 54 | Gas Cans (10-gallons or less) | Each | |
| 55 | Lawn mowers/snow blowers (or other small engine item) | Each | |
| 56 | Empty 55-gallon drums | Each | |
| 57 | 55-gallon drum with non-hazardous liquid | Each | |
| 58 | Ethylene glycol (one gallon) | Each | |
| 59 | Fire extinguishers | Each | |